

PROJECT COVER SHEET

THIS COVER SHEET MUST BE SUBMITTED AT THE TIME THE DRAWING AND DESCRIPTION FOR PHASE 2 OF YOUR PROJECT ARE SUBMITTED. The description and drawing should be placed behind this cover sheet, and the additional drawings for Phase 4 will be added to it when they come in, to keep a complete and orderly record of your project.

Project Number 5  
Date of Submittal 3.26.79  
Name of Student Artemis Anninou  
Project Community facilities-Bank  
Assigned category  
(Sm., med., or lge.,  
full or sketch) \_\_\_\_\_

If project is a building, indicate total gross floor area of construction (not site area), in square feet, of each of the following categories in the building complex:

Housing \_\_\_\_\_  
Shops & Restaurants \_\_\_\_\_  
Community functions 45,000 sq.ft.  
Hotel \_\_\_\_\_  
Offices 24,000 sq.ft.  
Industry 18,000 sq.ft.  
TOTAL HABITABLE SPACE 87,000 sq.ft.  
PARKING (in the structure  
or elsewhere) 90,000 sq.ft. (150 cars)  
(provided by the existing  
parking structure)

The project is a complex of three buildings, that forms a U shape open space facing S-W.

The first building of the complex, next to the Y.M.C.A. helps to define the pedestrian and car axis between the gate and the building passage.

This passage opens on to a medium size square, which is surrounded by the street and the three buildings. Their height varies from 4-5 stories. Along the long side of the square there is an arcade. Between the ~~other two~~ buildings exists a vaulted gallery under the freeway. It is a point of transition to the other part of the site. Standing there a nice view of the bay and the island can be enjoyed.

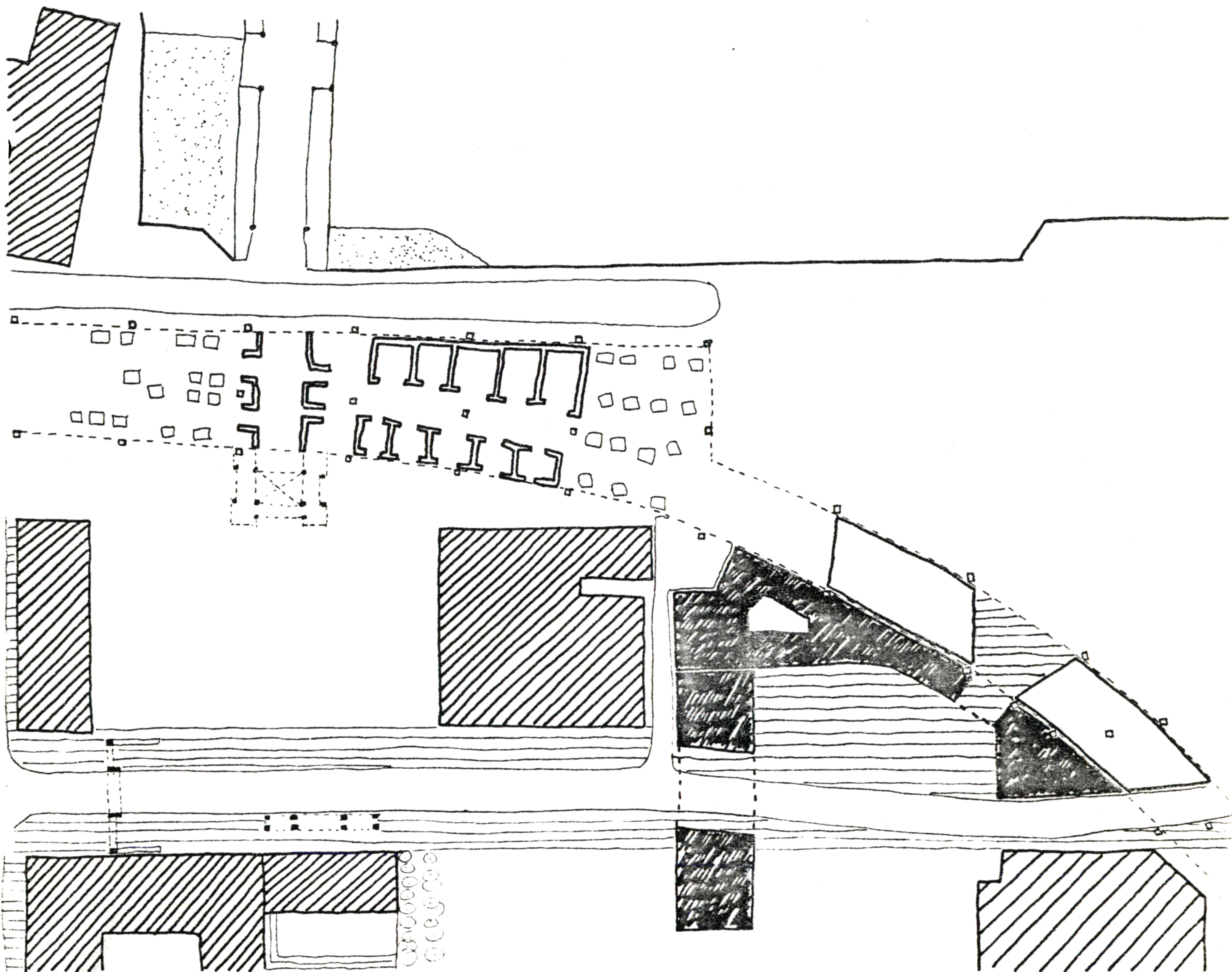

This project is composed of two buildings. The relationship between them becomes clear because of their contribution to the formation of the south-west boundary of the main square in such a way, that different levels of proximity on the square are created.

The first building, three storeys high, (facing the square directly), gives the first impression of a loose boundary. It leaves open the view to the second building, which is five storeys high and is located partly behind it forming the last end of the square. Between the two buildings runs the street that crosses the site.

The small building is consisted of offices and workshops for the community newspaper. There is a thoroughfare that crosses the building and gives the opportunity for a glimpse of the square for people walking along Folsom street.

The larger building is consisted of a small experimental theater and restaurant on the ground floor and of offices for the theater actors-, reporters-, and artists-unions on the floors above.

In the middle of this building there is a courtyard, which is reached after stepping, through a covered arcade. This courtyard

