



The main staircase at the Berryessa house, Christopher Alexander, Artemis Anninou, Gary Black and others, 1986

formed between them, generate the room's ancillary centers which make the light-filled room

truly a center, in the sense that we can feel its life and centeredness throughout the space.



8 / FINE STRUCTURE: THE BERRYESSA STAIRCASE

The two highly irregular configurations of the Berryessa staircase, are worth some discussion, too. It happens inevitably, from time to time, that an important volume has an unexpected

and slightly awkward shape. The volume of this staircase which leads down into the house from the entrance on the hill above, is shown here in plan. To make the space, I simply



The main staircase at the Berryessa house, looking down toward the kitchen, 1986

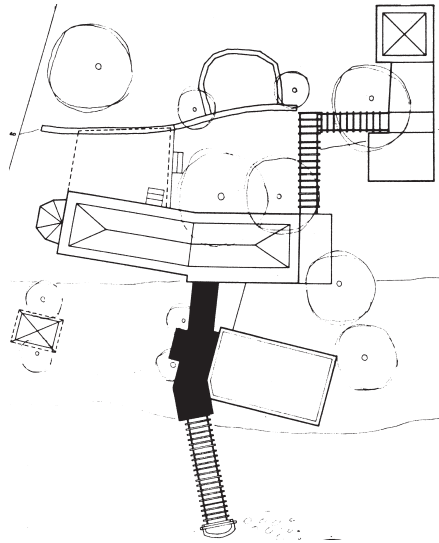

Staircase of the Berryessa house. The plan of this house, shown in full on pages 159-64, concentrates here only on the staircase, shown in black on the diagram. Christopher Alexander and Artemis Anninou, 1986.