

PROPOSAL FOR SATELLITE STUDENT UNION:

AGATE STREET DORMITORY AREA

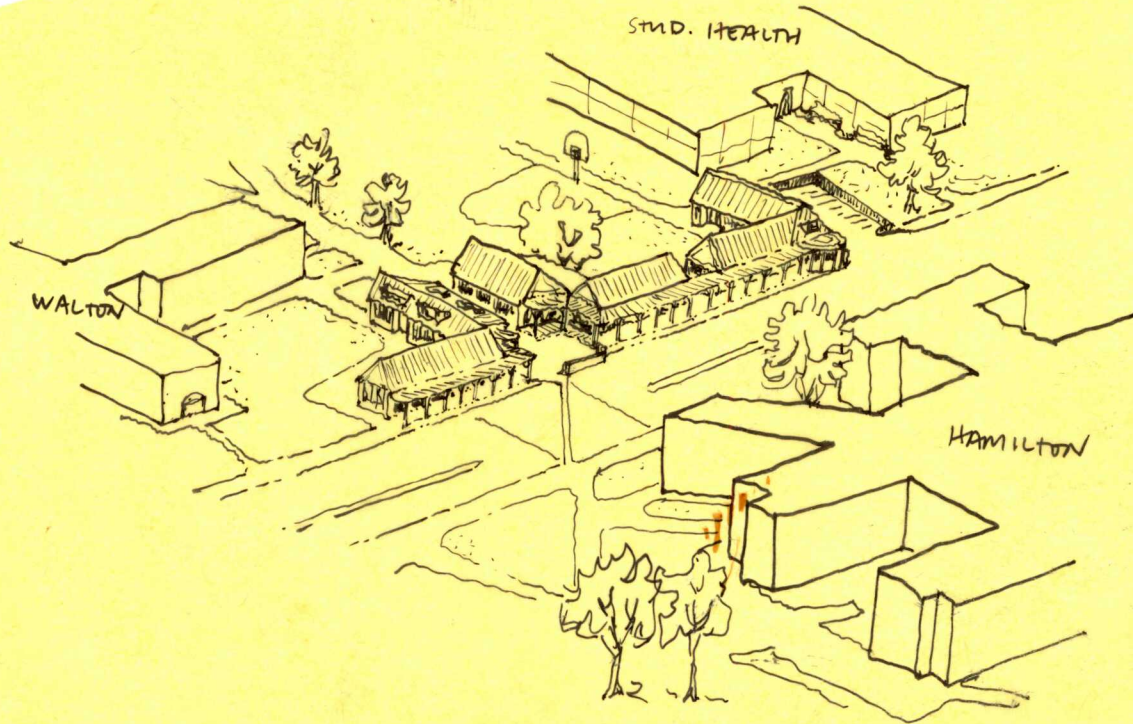

This is a project for a student union satellite near the Agate Street dormitories - Hamilton and Walton. This project is part of the package of five satellites that we are offering as an alternative to the current proposal for additions to Erb Memorial Student Union.

This project creates 5000 net square feet of student union space at a unit cost of approximately \$27.

FINAL PLAN

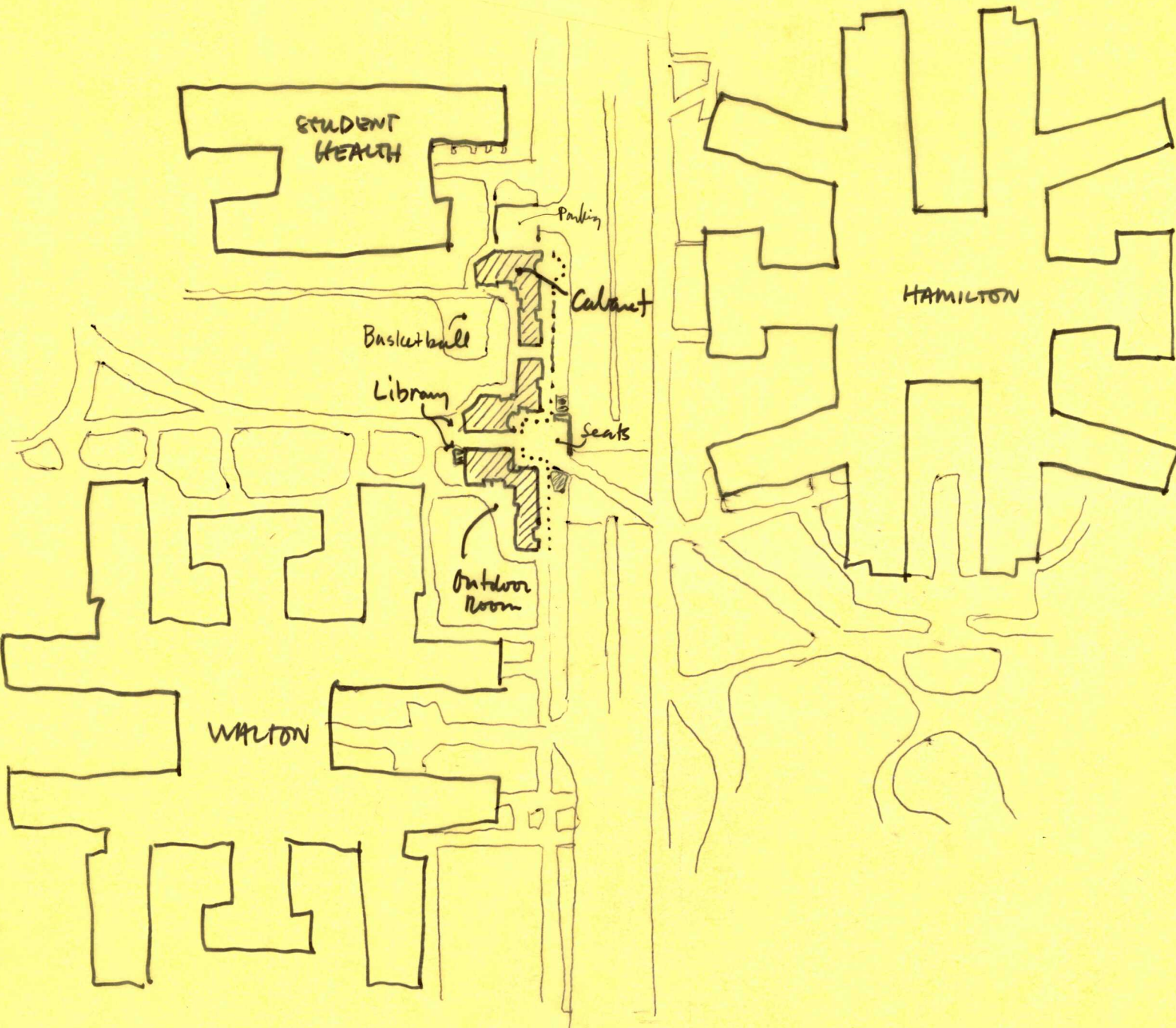

# STUDENT GATHERING

The sketch on this page is generated by the following patterns:  
No isolated student union; Activity nuclei.

- ⊙ ACTIVITY NUCLEUS
- ← - - - EXISTING PATHS
- ▨ FACILITIES

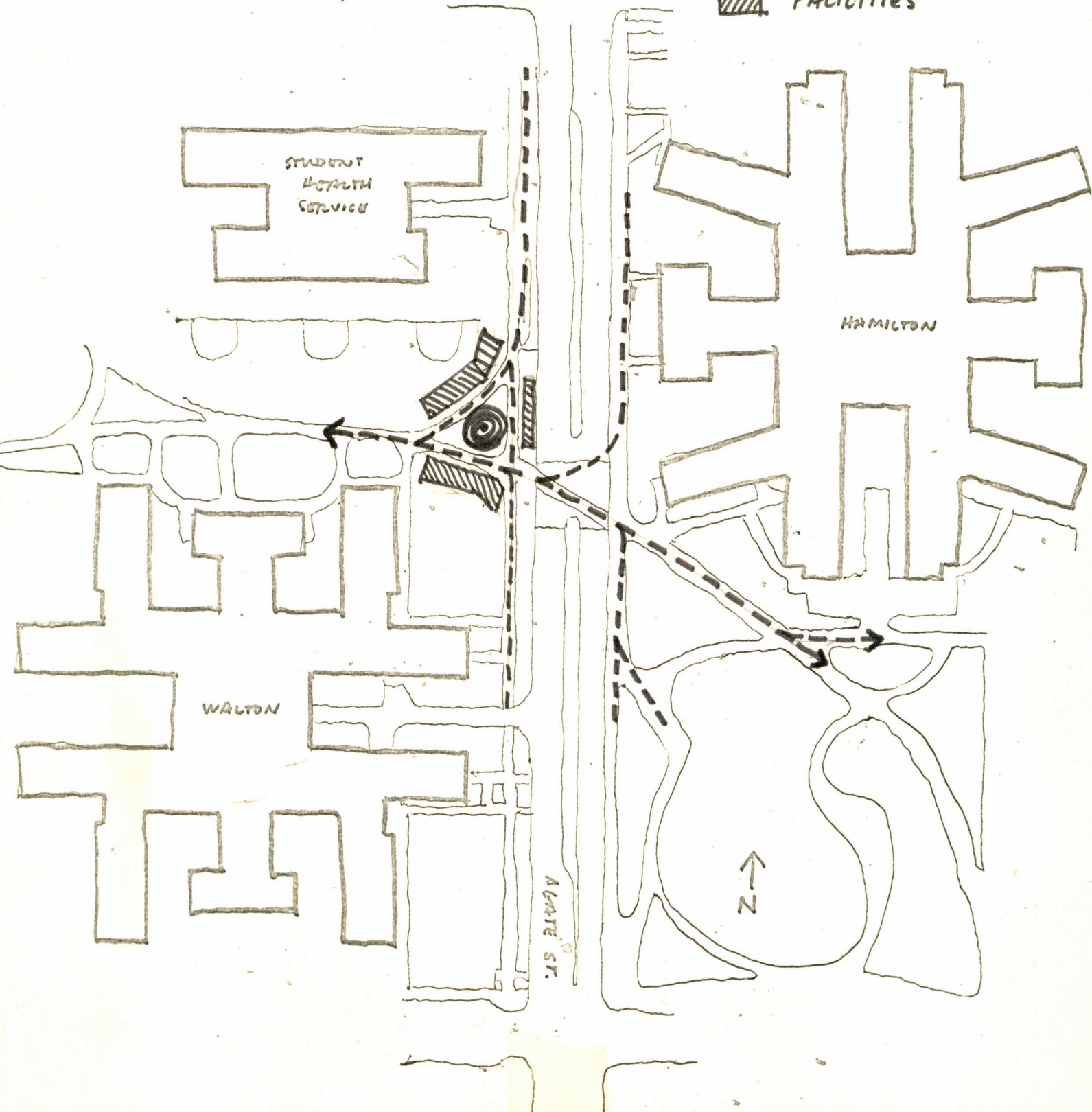

## PUBLIC BUILDINGS

The sketch on this page adds the following patterns to the design: Square foot assignment; Buildings shaped for light; Buildings surround open space; Human scale in public buildings.

 BUILDINGS

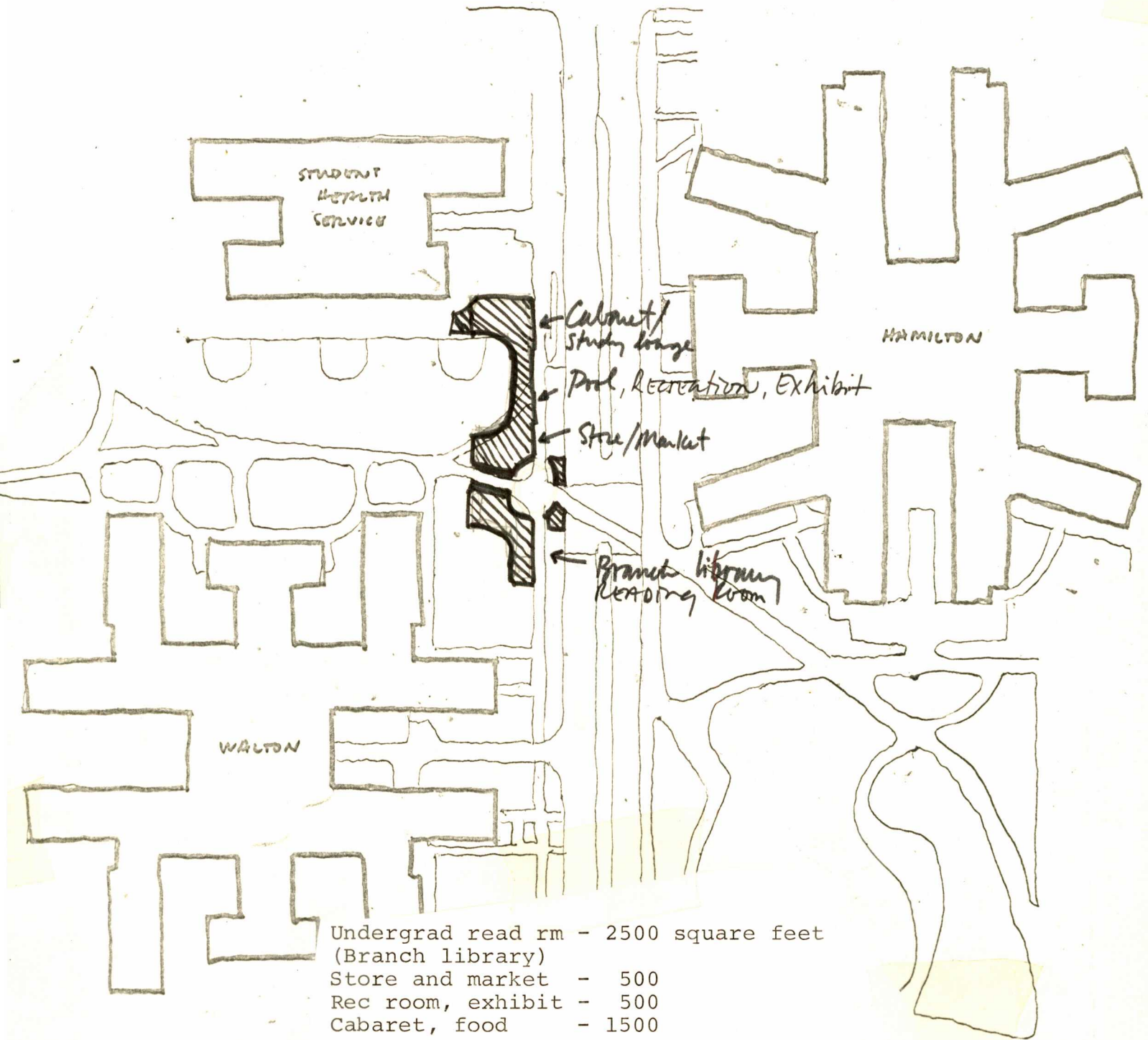

- Undergrad read rm - 2500 square feet  
(Branch library)
- Store and market - 500
- Rec room, exhibit - 500
- Cabaret, food - 1500

---

5000 net square feet

# PARKING

The sketch on this page adds the following patterns to the design: Short term parking; Commuter parking distance; Small parking lots.

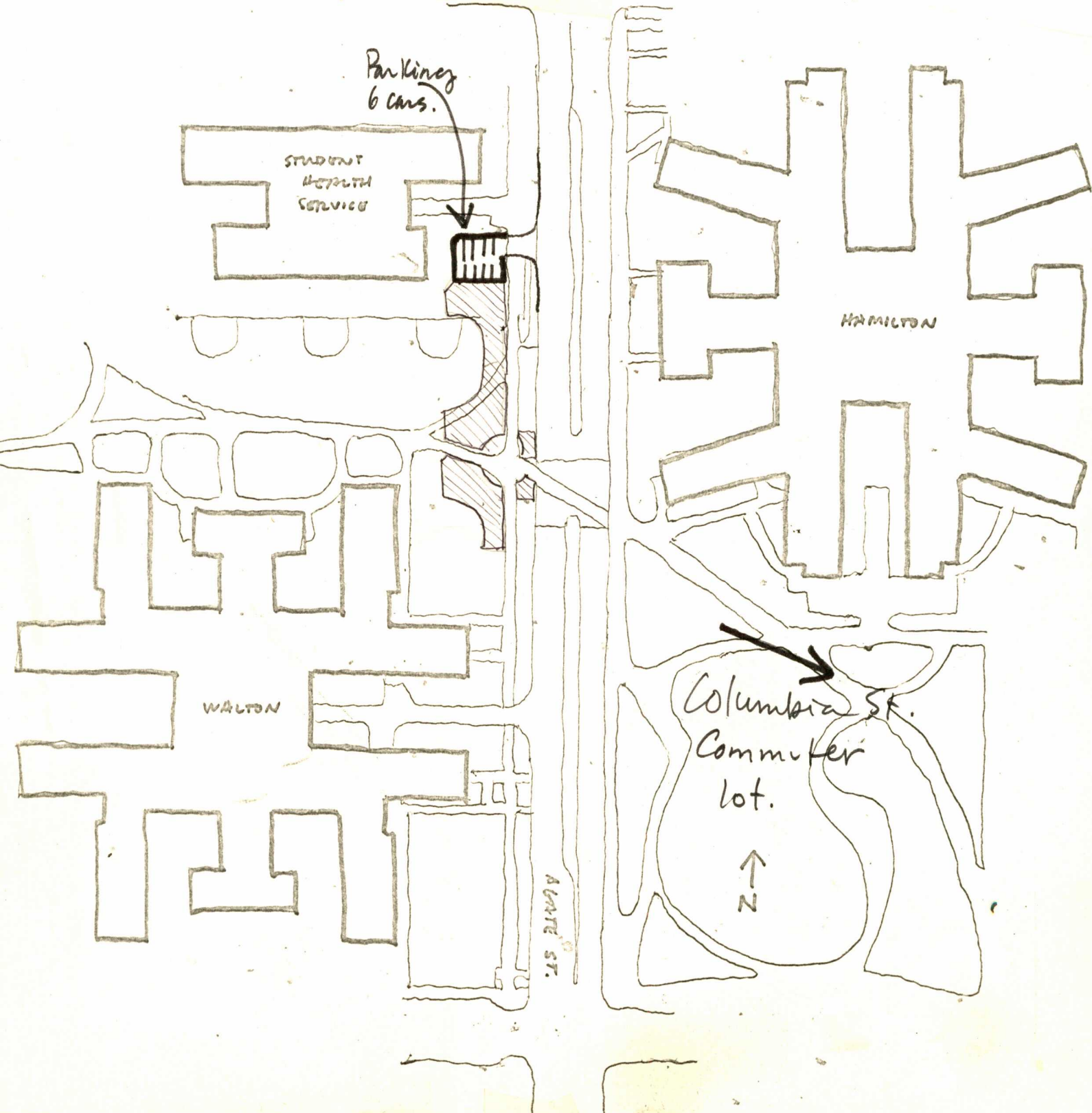

OUTDOOR PLACES

The sketch on this page adds the following patterns to the design:  
Small open spaces; Convex connected open places; South facing open space; Territorial ambiguity; Access to a green; Trees stay.

 New open spaces.

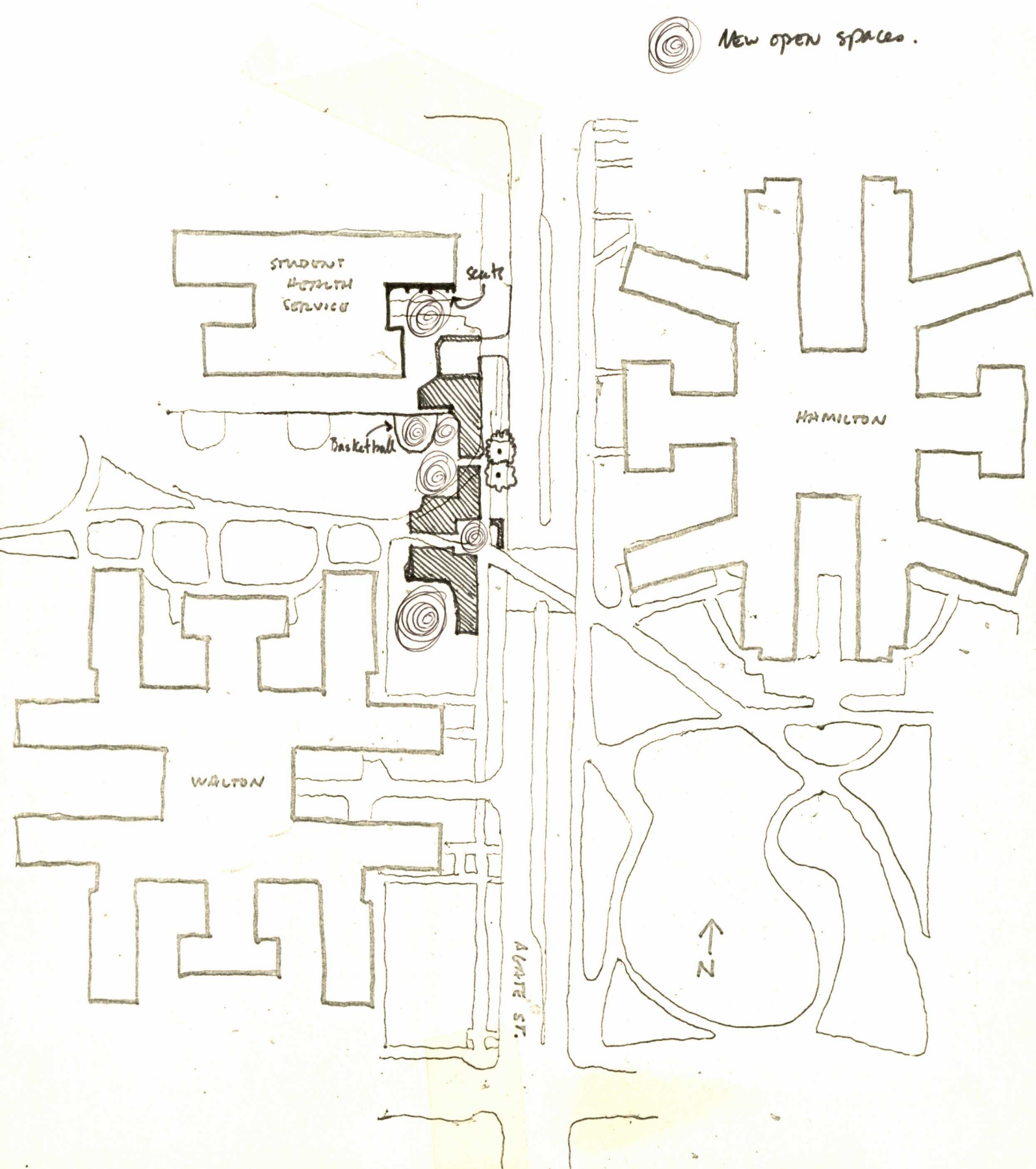

# ENTRANCES

The sketch on this page adds the following patterns to the design: Entrance location; Entrance transition; Entrance shape.

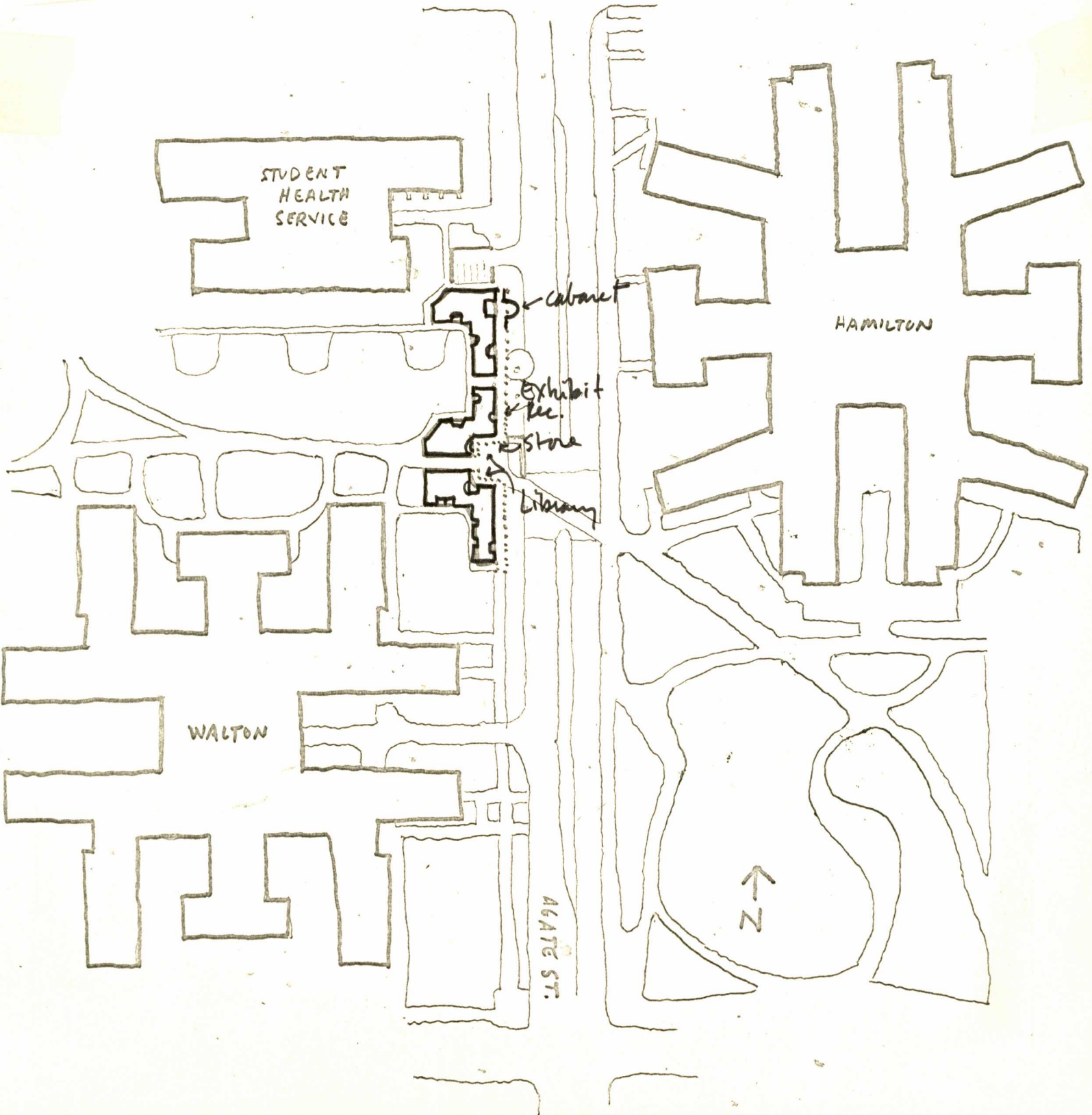

# BYCYCLES

The sketch on this page adds the following pattern to the design:  
Bike paths and racks.

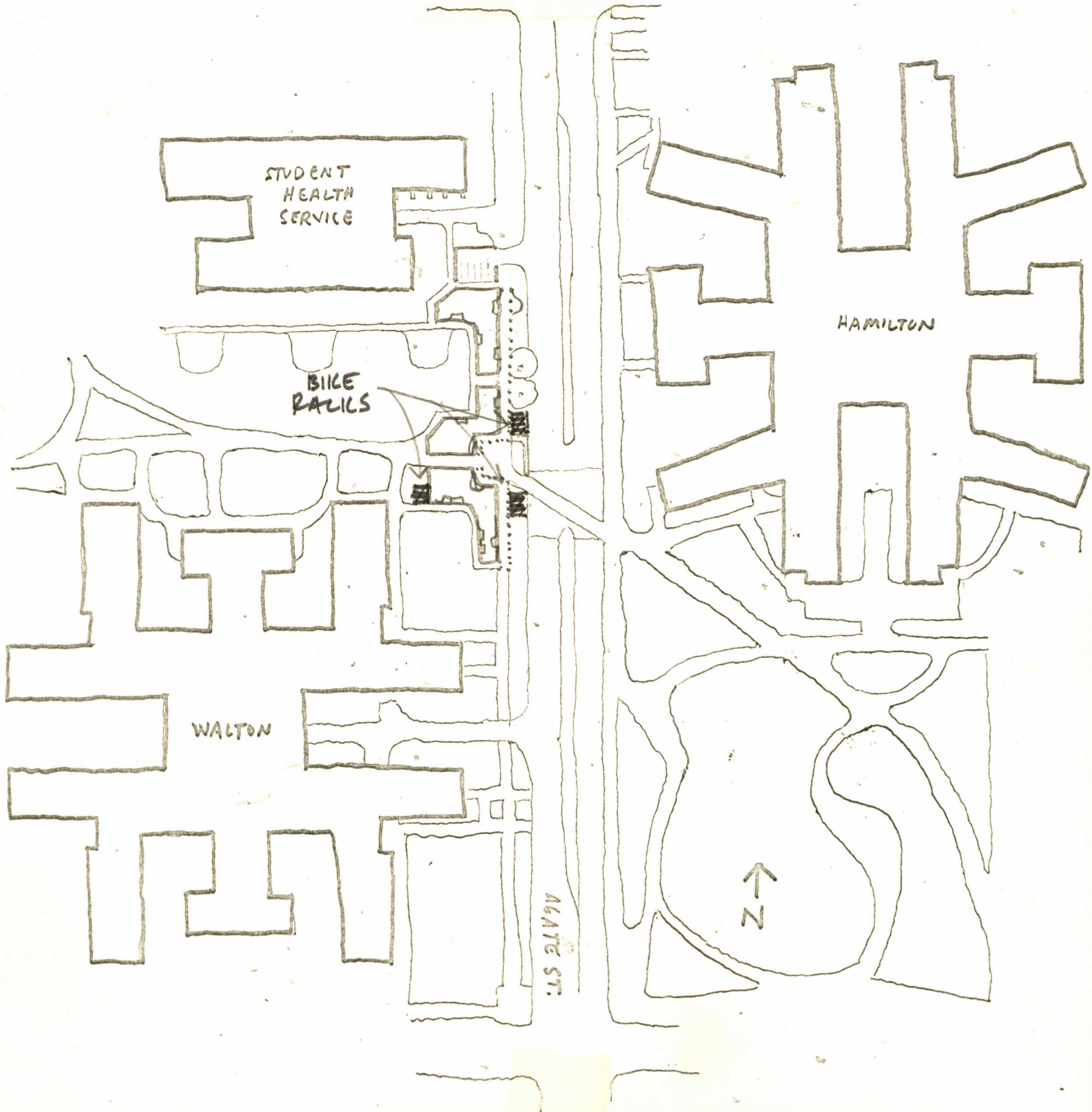



# PATHS

The sketch on this page adds the following patterns to the design: Territorial ambiguity; Paths interrupt roads; University as a marketplace; Street lighting; Centripetal pedestrian paths.

*/// Pedestrian Paths.*

