

ITEM D: CHANGE OF BUILDING SITE

This recommendation concerns the choice of a site for the Stanislaus County Community Mental Health Center. Up until the present, it has been agreed that the CMHC would be built on the piece of land to the East of the Scenic General Hospital. It is now recommended that it be built, instead, on the piece of land now occupied by the Probation Building, north of the Public Health building, and Northwest of the hospital as shown on the Site Plan, Item C.

The reasons for this recommendation are:

1. Since the CMHC will no longer contain inpatient beds, there is no longer any reason for a close and direct connection with the hospital. Required inpatient services will be provided in Emanuel Hospital.
2. Since some of the beds in the existing hospital will be devoted to minimal use by inpatients, and there is a reason for some loose connection with this area, we suggest that the west wing of the hospital now occupied by the tubercular ward, is the most suitable, and that it would therefore make good sense to place the CMHC near this wing.
3. The program relies heavily on the use of therapeutic community principles in order to affect the socialization process, and will emphasize helping people who have become withdrawn and isolated from their fellows; medical treatment per se plays a relatively minor role in the program. It is therefore important that the CMHC have a setting conducive to that kind of program and this means that it should form a partly self-contained precinct, separate from the hubbub of hospital

traffic - the northwest site is far better suited from this point of view, than the eastern site.

4. The type of treatment in the mental health program will rely largely on the concept of the therapeutic milieu, and it is essential, therefore, that patients have an opportunity to work and play out of doors, as well as indoors. The eastern site is too small to allow any functional use of open space - the northwest site is well suited to it.

5. For a variety of functional reasons, it is desirable that each of the treatment programs within the CMHC - namely, adult day treatment, adolescent day treatment, child day treatment, outpatient teams, and the crisis intervention team - should function as self contained teams, and to this end, it is essential that they be housed in a complex of at least partly separate small buildings connected to one another. While it is possible to design such a complex on the northwest site, it would be virtually impossible on the eastern site.

All these reasons point to the same conclusion: namely, that the CMHC be built on the northwest site, where the probation building now stands.

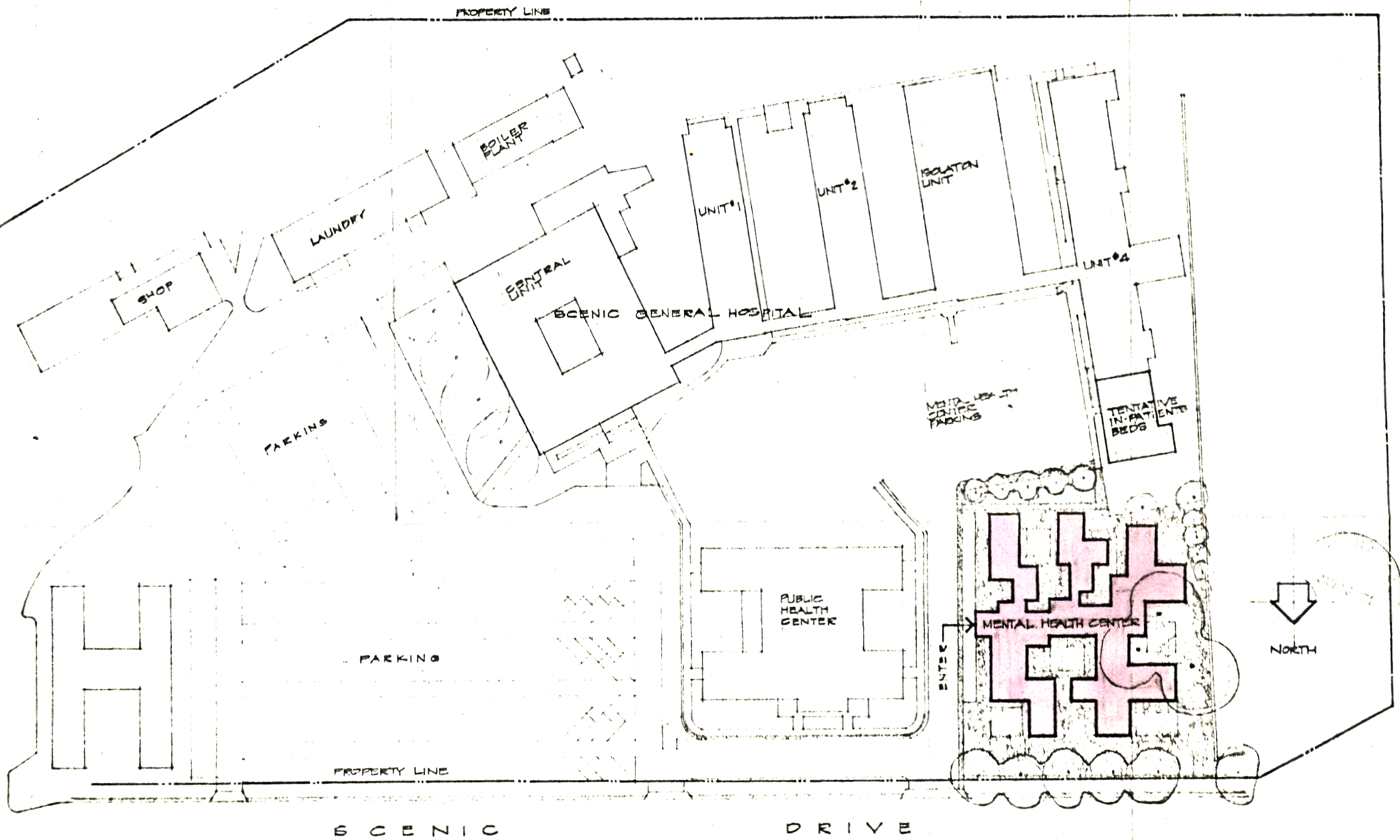

SITE PLAN

Scale: 1" = 20'