

LAYOUT, DAY 1

Today, we are going to the site together for the first time. in more than a year. All the families living on the moshav Shekanya, will come, and we will, together, make the first decisions about major centers ~~XXXXXXXXXXXXXXXXXXXX~~ for Shorashim.

We shall discuss the following points:

1. The overall location of where we intend to build. The main spots, in general.
2. The overall diameter of the first community of about 15 houses. ~~N~~ And perhaps also for about 30 houses. This is for people to get some idea of scale, and some idea of respective distances.
3. The nicest points. The points which will become the main nodes - so far only with the vaguest idea of what might actually be built in them.
4. The place where the road comes in. The position of the main parking lot.
5. The direction of the main street, and its position if possible, perhaps also with the probable location of ~~thXXXXXXXXXXXXXXXXXXXX~~ that part of the ~~main~~ main street which will go on, when the next houses are built.

SECOND DAY TASKS

We need to place ~~the~~ certain major items, which will make the plan so far developed, half way real. These are:

1. The hostel.
2. The larger industrial buildings.
3. Find out how many people want their houses near a public square or public street, and how many would like to go in a more private area.
4. The synagogue.

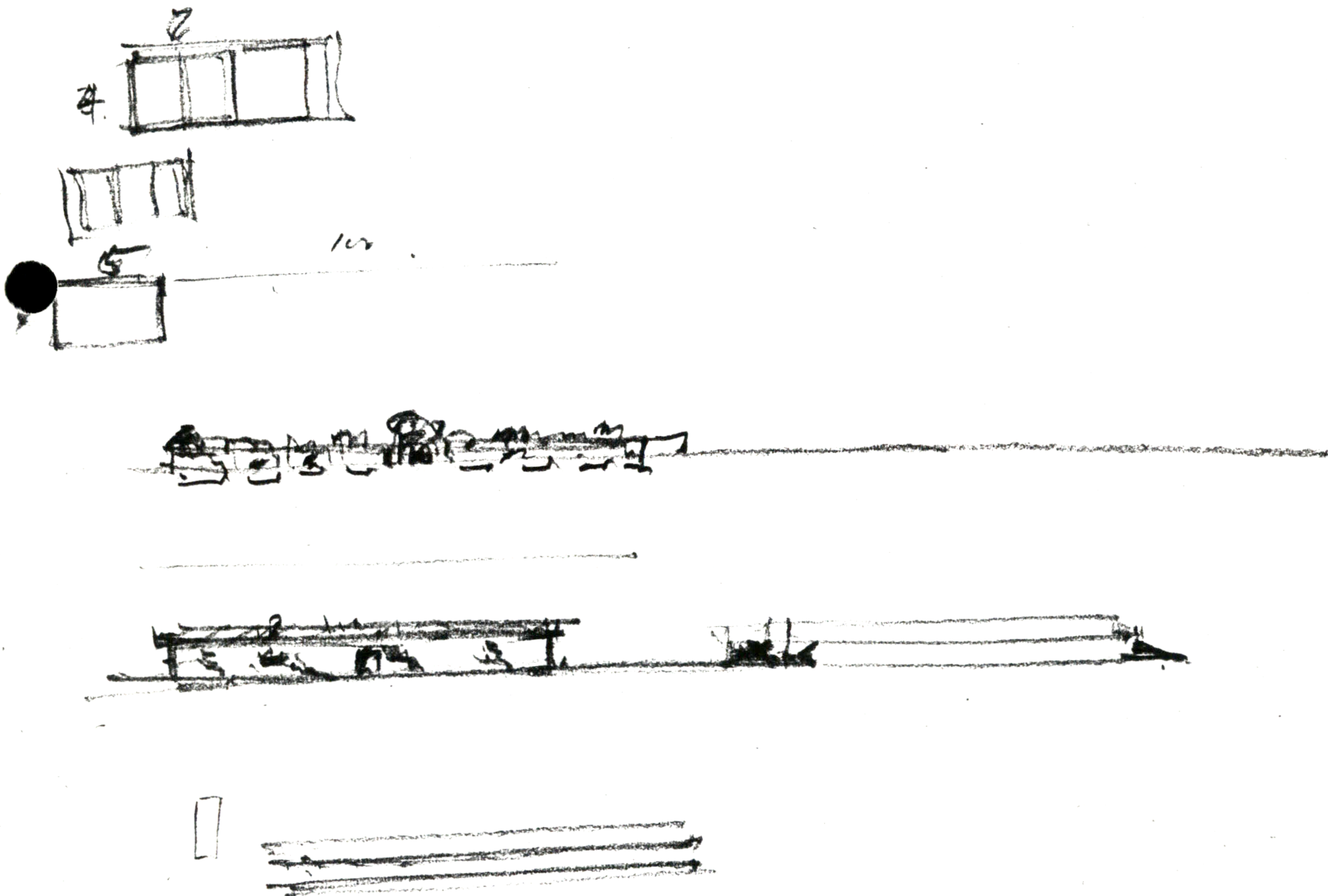

SECOND DAY TASKS

What are the ~~open~~ open questions right now.

1. Is the ~~broad~~ road coming in ~~in~~ ~~the~~ ~~right~~ ~~direction~~ to the right rdepth... and in the right way.
2. Is the central park more of a park or more of a square and does this have any implications.
3. Is there a walk along the edge, ~~mm~~ and what might be along it if there is.
4. Should the settlement be extended, at this stage, above the main square... starting to go up the hill.
5. Very roughly, where would people tend to want their houses - a broad statistical picture, so we get some idea of what to work with.
6. Are there any basic errors at the moment... basic feelings that something isn't quite in the right place.
7. What about the fact that there still is no "urban" center.. it is a park... but not a small square.
This "urban" center should be connected to the road.
8. The nodes are too "cute" just now. There is no solid sense of real built places, which have the quality of small squares.
9. Is the middle flat mainly to be left empty, with future ~~na~~ playing field, tennis, football ~~mm~~ even agriculture =.. or ~~mm~~ is it to be built up, filled with house clusters.
10. Is the hostel all in ~~one~~ one place... and if so, where is it.
Total length of hostel,

THIRD DAY .. OPEN QUESTIONS

1. The main street is still in doubt... we may use the original idea of a chain of nodes around the circle instead and must check out which is better.
2. Position of angioscan workshops is very unclear.
3. The emptiness of the big circular flat could still be a problem.
4. We have to check the "next" node above the main center, and make sure that it is not too far, and that it fits in in a natural way.
5. The way the road might form a loop id rather unclear...
6. Not sure what buildings around the main square will actually "form " it. Should it be the children... is that OK if that is actualy the center of community life.
7. Need to know how far apart children and main workplaces ought to be.

COMMENTS ON COMMUNAL PLAN AT END OF THIRD DAY.

A few problems still exist with the plan at this stage.

1. There is no gateway... no very ~~good~~ good sense of arrival in the ~~village~~ village.
2. We have not yet made anything out of the ~~beautiful~~ beautiful idea that as one walks down the main street, you catch glimpses of the trees to the left, through arched openings or gateways between the workshops.
3. There is a question about the specification of the road, to be sure that it is not obnoxious, like present Israeli roads.
4. It is a question whether the buildings in the public domain should be ~~two~~ two storey or not, to give them and the space they surround, more weight.
5. We have pretty much decided that public buildings will have tiled pitched roof... and that private houses will have flat roof with parapet, so that the roof can be used, can have expansion, and is cheaper.
6. It seems best to imagine that the paths and walkways, paving, steps, ~~and other surfaces~~ and other surfaces will start ~~to~~ to be built right away....
- 7.

FOURTH DAY

Today we are going to have the families place their own individual houses.

First, we take everyone to the site, and walk them through the public space so that they understand how the public space works. We made the mistake, the night before of showing it for discussion on paper... and got quite a few negative comments... most of them based on the fact that from the ~~map~~ paper, people did not get the feeling of the site... and did not trust the decisions made by the moshav members who had helped to lay it out.

Now, on the site, itself, people have a better understanding of how the thing works.

~~When~~

We now ask each family to survey the possible places for a house, look around, walk the site, and find the place that most touch them, mean the most to them. We suggest that this be done also, with some natural feeling for groups .. but this suggestion is very delicate, so that families do not feel themselves under pressure to make "choices" ...

The process works beautifully. ■ In spite of very serious worries the night before, expressed by certain people, that it would be necessary to have a lottery, in the actual fact, people distribute themselves quite freely, and there are almost no conflicts... even though a few choice spots are very beautiful.

People are elated, very happy indeed with the spots they have chosen.

I have made it clear that the spots people ~~choose~~ choose must be considered as possibilities... not as absolute choices... since we may need some leeway to solve problems, but will stay as close as we can to peoples individual feelings.

~~When~~ Finally the clusters stabilise, people fix a certain spots... and we take a survey to get these spots on the map.

~~When~~ When we place houses at the various given spots, we find that the structure is rather ~~incomplete~~ incomplete... that it is incoherent, because families have acted in a way that is too individualistic .. and we forgot to tell them that each thing they do has to contribute to the whole. We can correct this, to some extent by modifying a few locations, and by inserting houses that are going to be built ~~without~~ without families.

FIFTH DAY PREPARATION

We are now going to place the exact outlines of buildings, so as to form ~~XXXX~~ common space exactly.

We must first resolve some minor conflicts which exist as residue of previous days work in locating houses.

And we then prepare ourselves to work with each family to define the perimeter of their house, the front door, ~~ZNDMZME~~ and the private outdoor space. When this is correctly done, we may then, afterwards begin the process of designing the houses themselves.

I explained to the families, last night, that the overall perimeter of the house is not to be defined by the internal needs of the house, but rather by the way in which each house makes its contribution to the larger whole that it is a part of.

People found this surprising... so it is worth remembering to make this more clear in future.

SIXTH DAY

We have had a three day break, to overcome some hard feelings.

The task, now, is to get each group of buildings, whether they are houses, or public buildings... and form the space which these buildings create, with entrances and gardens ~~mmmm~~ and the volume of the building clear.

The groups that are relevant in this:

1. Louis, and synagogue (Louis, Sue, perhaps Danny).
2. Mark ~~and mmmmmmmmmmm~~, David and meeting hall... which is done by Frank, Dita, Amy
3. Danny, Frank (G) to form cluster round tree, perhaps Andy.
4. Gary, ~~Steve~~ Bellins, Lillings.
5. Klatek, perhaps Andy.
Ellen Ann Marylin
6. Grocery, and Office and Gan. b Ellen, Roberta Rachel ~~Ann~~
7. ~~Workshops mmmmm~~ Small workshops group. and large workshop.
8. ~~Hammond~~ Hostel
9. Builders yard and Frank.

10. *Na'aman, Zwi, Amy*

TASKS FOR NILI

1. Get land use plan approved.
2. Find out conditions for site plan to be submitted, and phone me.
3. Develop infrastructure, in a way consistent with the paths we have.
4. Look for building details. that can be used now.
5. Get soils report, and get variety of foundation types.
6. 11.500

20% of budget for

arcades
follies
walls
balustrades
paving
walks

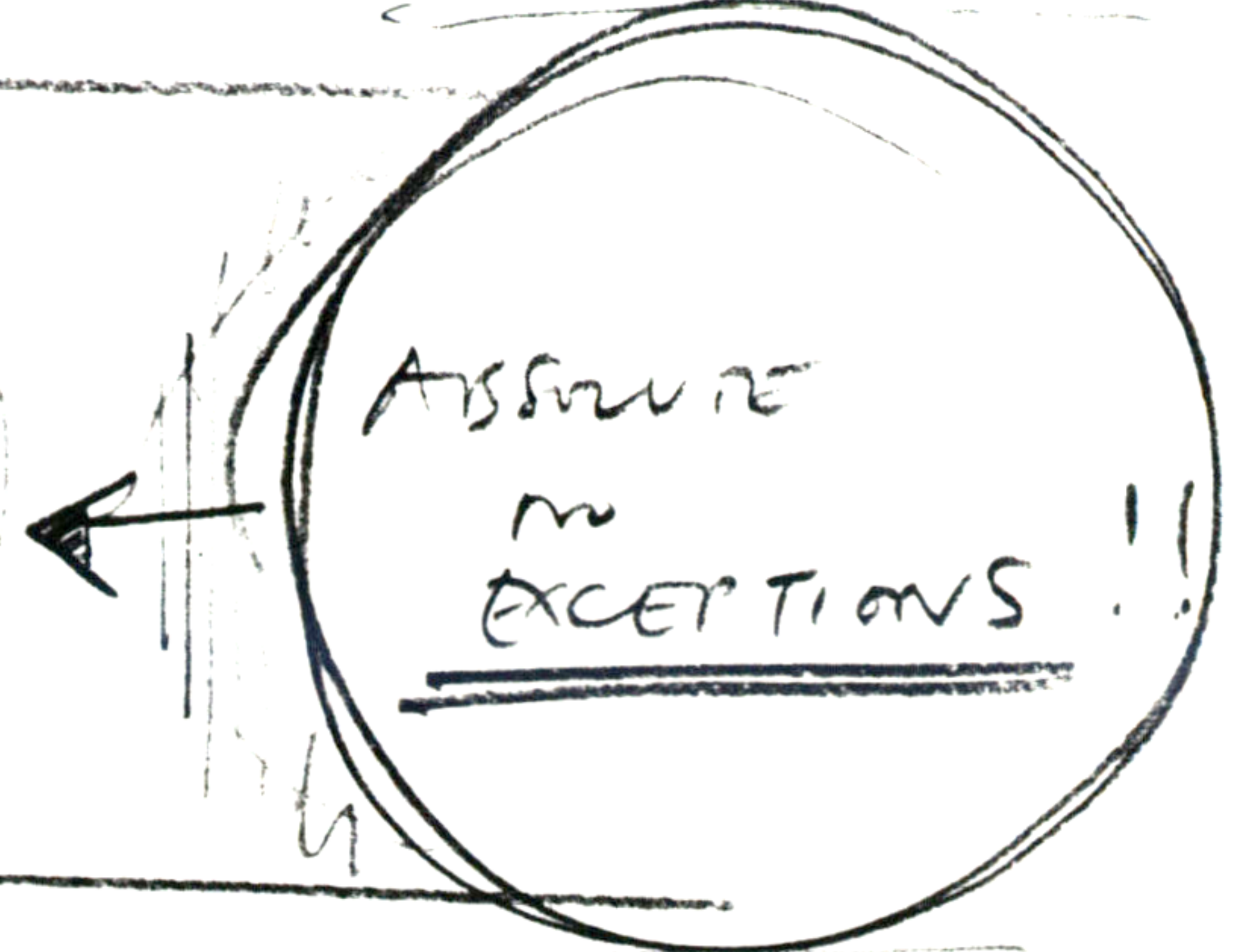

~~15~~ 15 @ ~~100~~ 64 m²

960

10 Apartments 42 m²

420

Synagogue

180

Chinic

25

Landscaping

100

Cafe

50

Office

30

Screen slip + stage

80

Workshops }
2 @ 20
2 @ 50
1 @ 200

320

Builder yard

160

Shed + fire
150 10

2325

+ 20% →

Communal
Outdoor stuff equiv 20%

464 (equiv construction)

2789

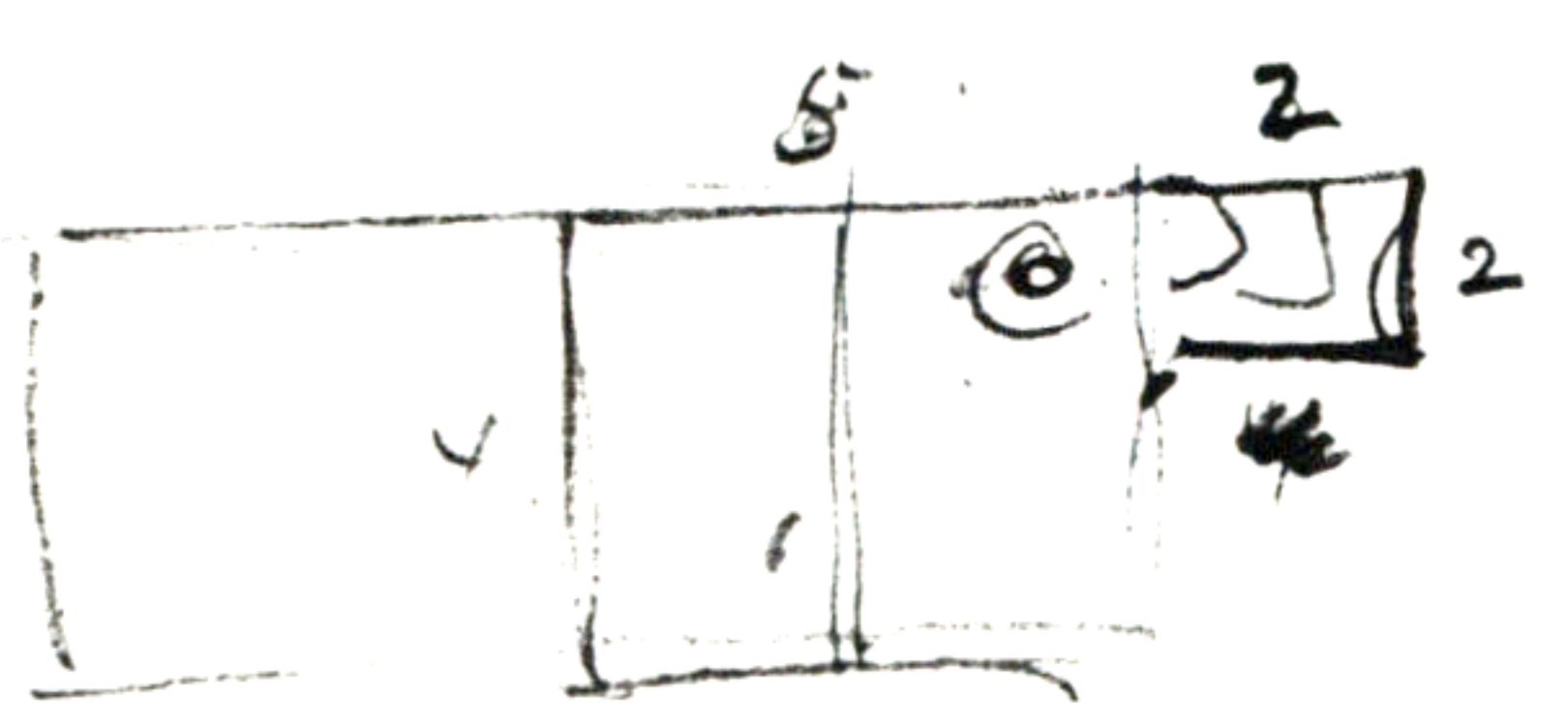

3x5

20 + 150 + 4

+ Infrastructure extra



2000.

12 units @ 70	840	
10 apartments @ 40	400	
2, vestibules @ 80	160	
1, amen @ 200	200) 360
dry room @ 180	180	
landscaping @ 150	150	- 100
office, shop, cafe @ 150	150	100 + 40
clinic @		
	<u>2080</u>	25

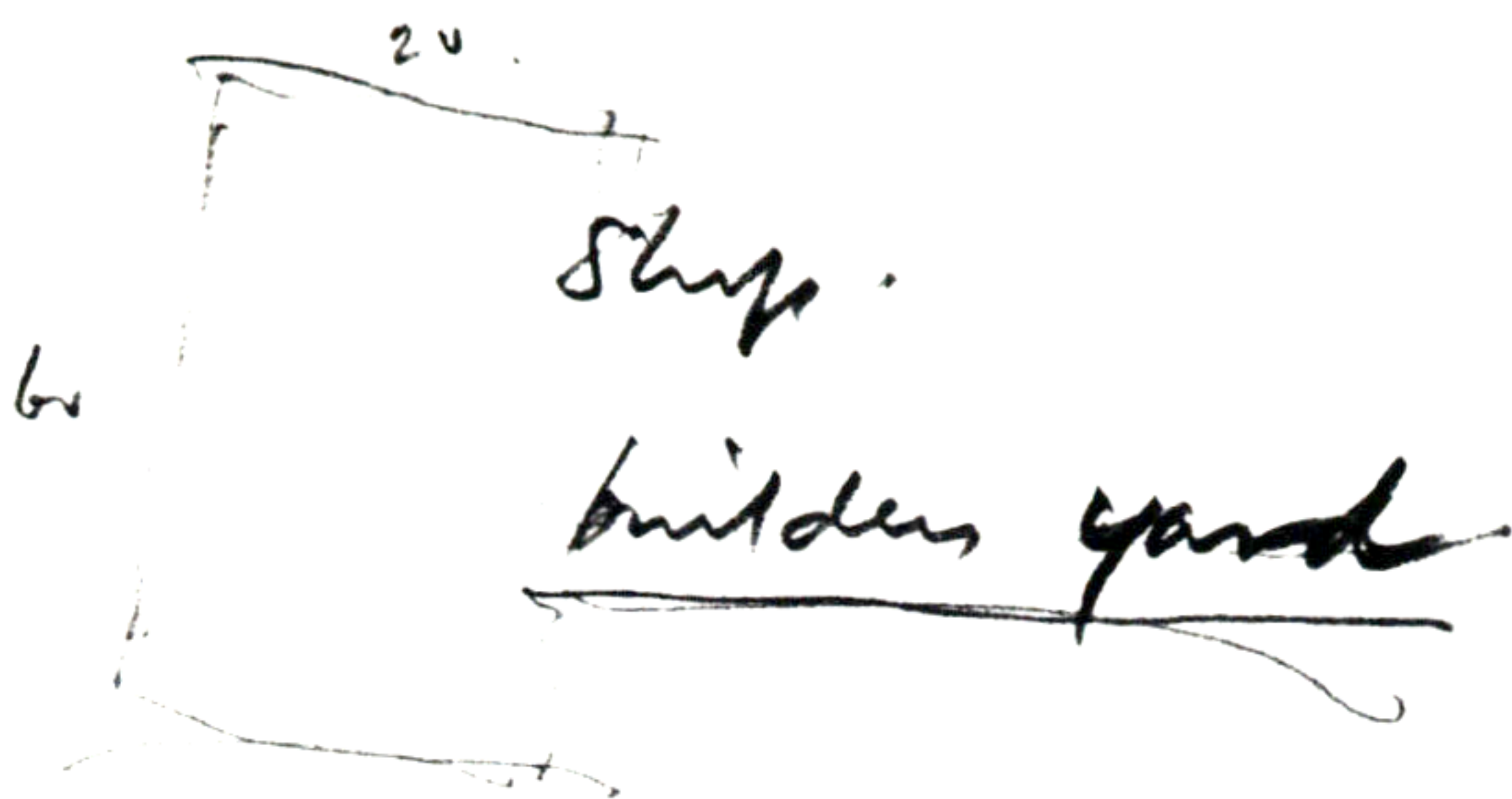

+20% arcades
 bellies
 balconies
 balconies

