

SCALE 1:200
SECTION

Artemis: Please call me tonight at either 64-3494 or 64-2990 if not at my home (→).
OR tomorrow sometime at my house.
Thanks.

embankment boundary wall - has a fence & pasture land on top which continues at same level westward.
Note: when natural slope is higher than 1:1, probably we should use balcony verandas.

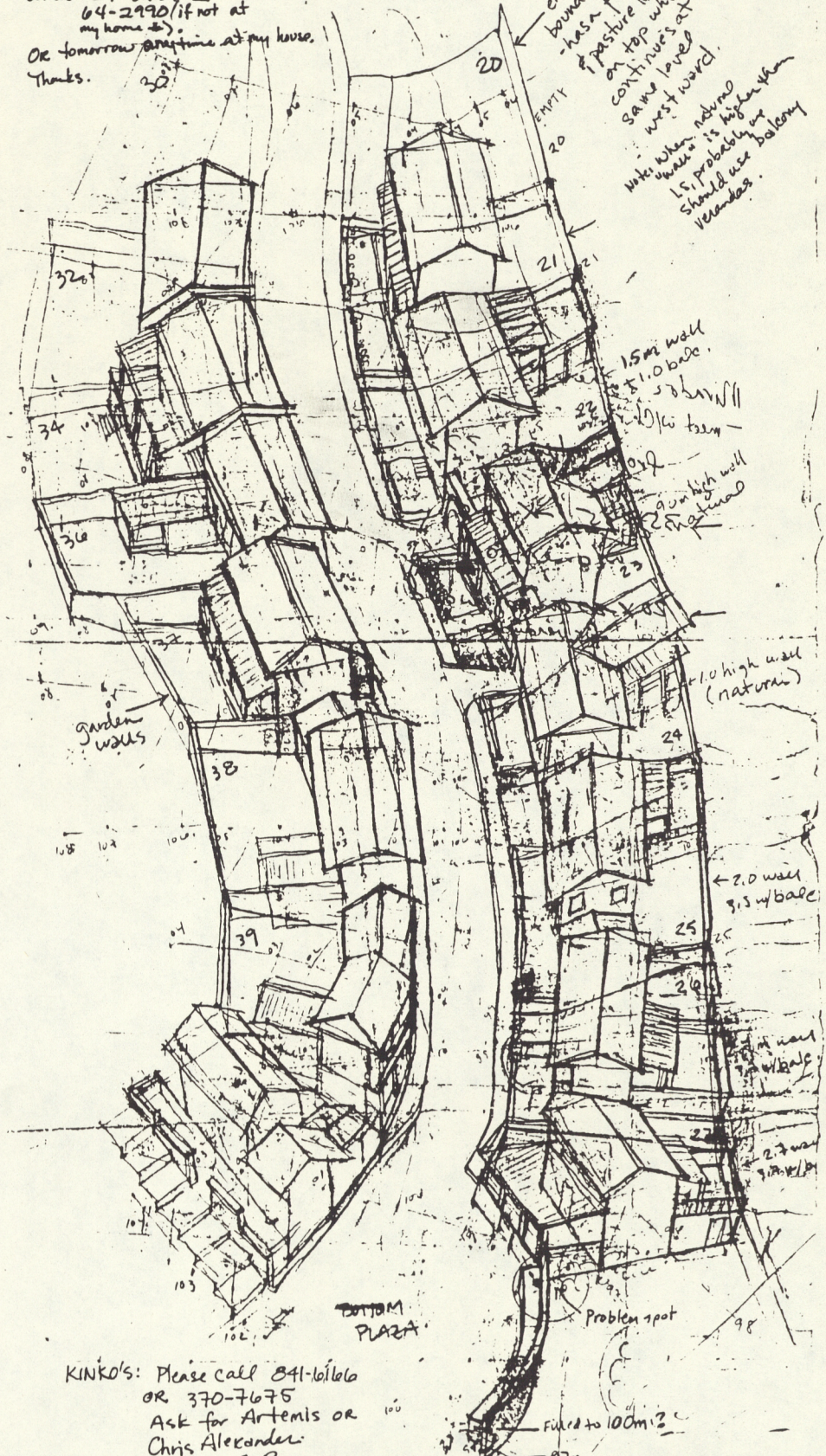

KINKO'S: Please call 841-6166 OR 370-7675 Ask for Artemis or Chris Alexander. A.S.A.P. Thank you.

SCALE 1:200

Drawn close together