

1/2" concrete
 wire mesh
 building paper
 3/4" plywood
 2"x4" @ 2' intervals

3/4"x3/4" molding
 6"x8" beam D.F.
 1/2"x2" molding
 4"x6" beam D.F.

4"x6"
 4"x6" on 6"x8" beams
 1/2" polystyrene
 3/4" plywood
 1/2" sheetrock

PITCHED ROOF AND CEILING CROSS SECTION

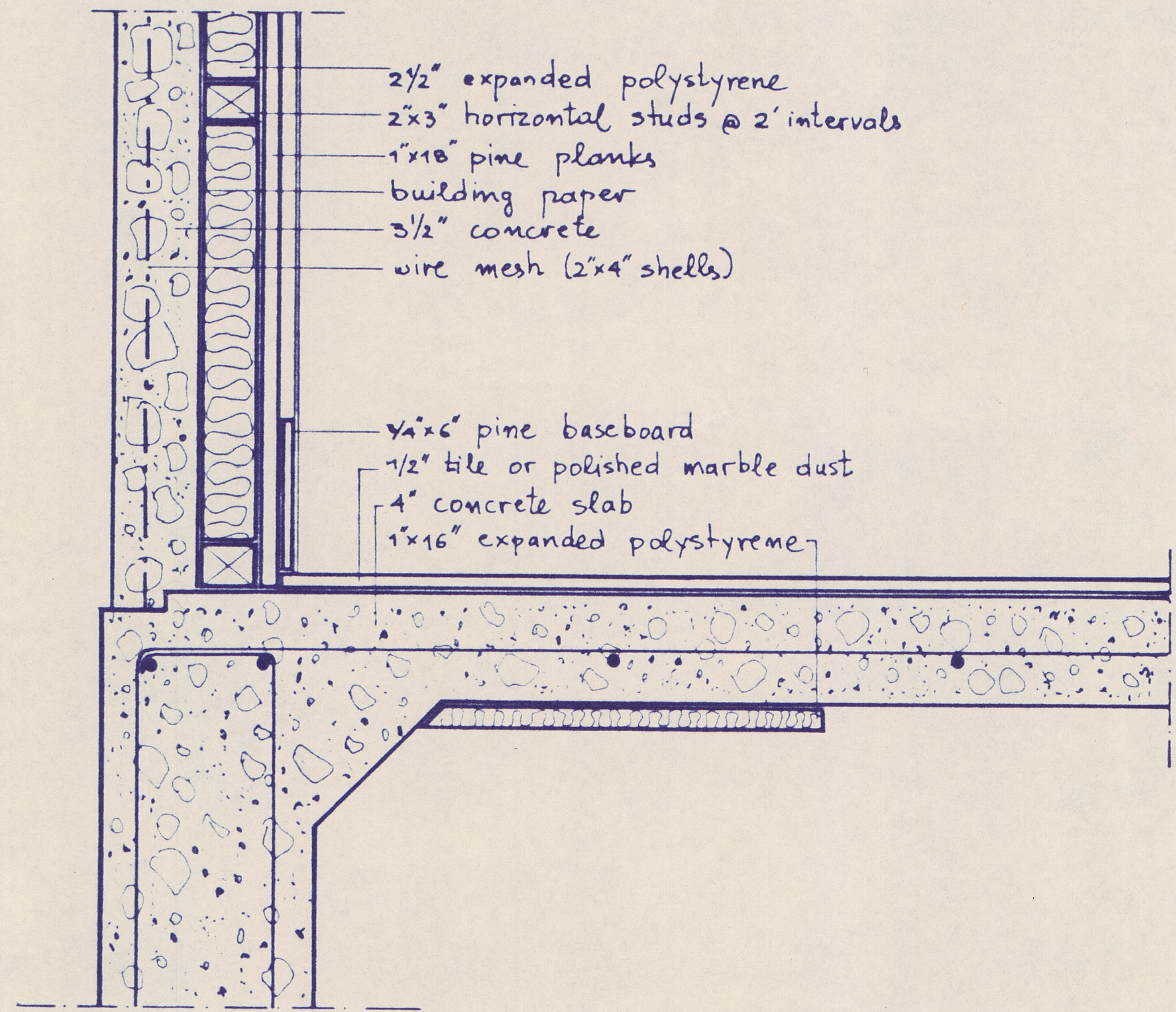

2 1/2" expanded polystyrene
 2"x3" horizontal studs @ 2' intervals
 1"x16" pine planks
 building paper
 3/2" concrete
 wire mesh (2"x4" shells)

1/4"x6" pine baseboard
 1/2" tile or polished marble dust
 4" concrete slab
 1"x16" expanded polystyrene

FLOOR AND TYPICAL WALL VERTICAL SECTION