



arlemis aminou • Kostas-paul Trajan

ARCH 201 FALL

BERKELEY DEC. 05 1978

ΘΕΣΣΑΛΟΝΙΚΗ

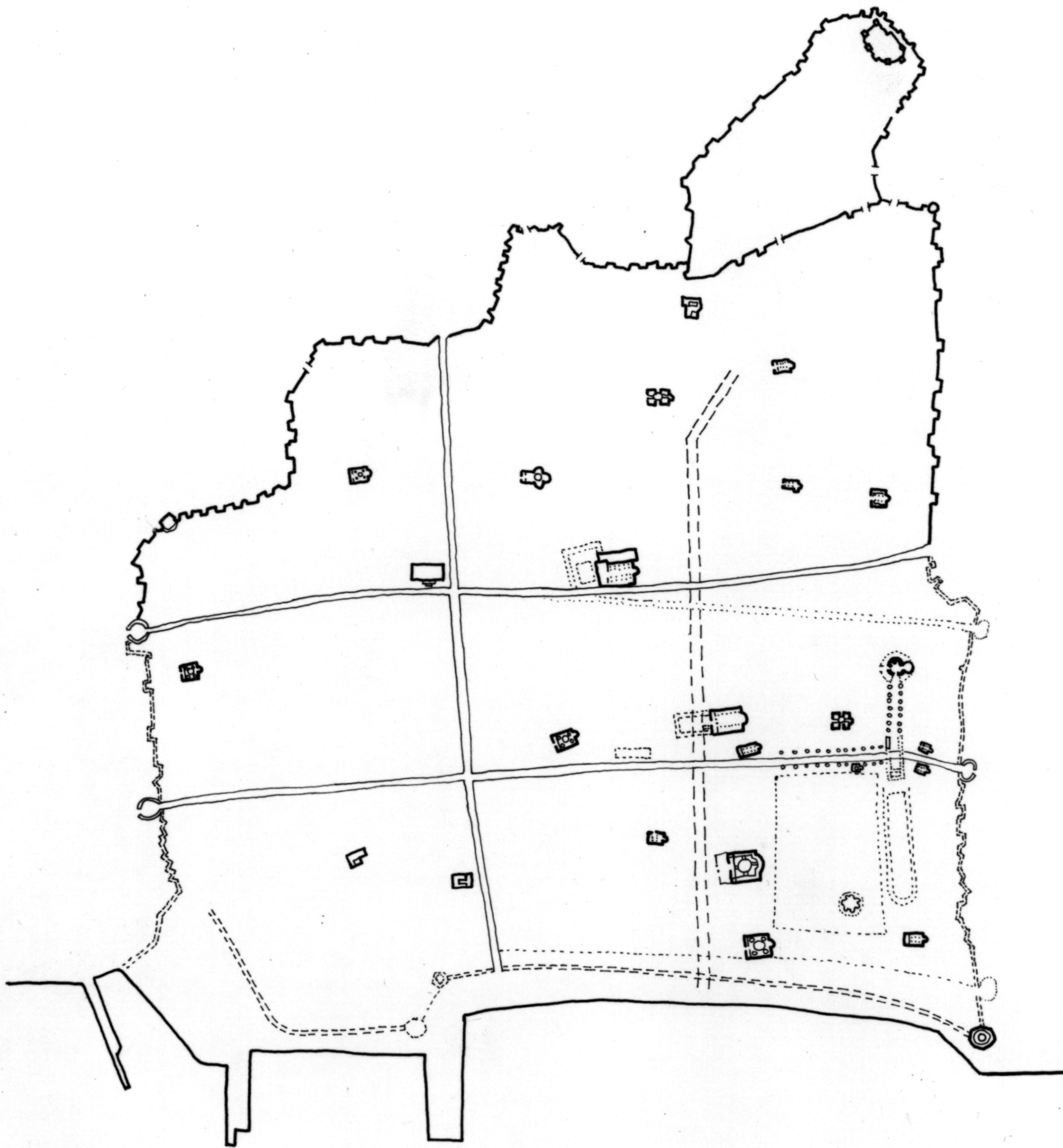

* THESSALONIKI (335 B.C) HAS ALL FUNCTIONS AND ELEMENTS BUT NO HARMONY (CFR. HUMAN BODY)

OLD HISTORIC CENTER (65.000 INH.) IS A POOR AREA WITH LITTLE OR NO INFRASTRUCTURE, MOST OF THE MONEY IS SPENT ON RESTORATION OF EXISTING MONUMENTS.

* CENTERING PROCESS

WE GIVE EACH EXISTING MONUMENT - AS NUCLEUS - A SPECIFIC MAIN FUNCTION AND SURROUND IT WITH ALL OTHER GENERAL FUNCTIONS TO MAKE "COMMUNITIES OF 7000" ALIVE

ON HIGHER LEVELS (PARTS OF THE CITY AS CENTERS, WHOLE CITY AS A CENTER) THESE SPECIFIC MAIN FUNCTIONS ARE IN HARMONY AND CREATE A WHOLE,

ON A LOWER LEVEL THE SPECIFIC AND GENERAL FUNCTIONS OF THE COMMUNITY NUCLEUS SUPPORT AND FEED NEIGHBORHOOD ACTIVITY NODES, WITH MORE EMPHASIS IN THE LATTER ON DAILY LIFE, WORK ENTERTAINMENT, HOUSING

* ON EACH LEVEL THE BASIC IDEA OF CENTERS GUIDES US IN SELECTING AND APPLYING THE RIGHT PATTERNS TO LET THE CENTERS GENERATE LIFE AND CREATE HARMONY

CITY AS A WHOLE

19. WEB OF SHOPPING
21. FOUR STORY LIMIT
22. NINE PERCENT PARKING
24. SACRED SITES
53. MAIN GATE
7. COUNTRY SIDE
25. ACCESS TO WATER
16. WEB OF PUBLIC TRANSPORT
34. INTERCHANGE
43. UNIVERSITY AS A MARKET PLACE

* WITH A MONUMENT - HAVING A SPECIFIC FUNCTIONS
AND BEING SURROUNDED BY ALL OTHER GENERAL
FUNCTIONS - AS ECCENTRIC CENTER:

BOUNDARIES, DENSITY RINGS, LOCAL TRANS-
PORT AREAS, INDUSTRIAL RIBBONS ETC...
GET SHAPE AND BECOME ALIVE

SEVERAL COMMUNITIES

- 12. COMMUNITY OF 7000
- 28. ECCENTRIC NUCLEUS
- 29. DENSITY RINGS
- 44. LOCAL TOWN HALL
- 46. MARKET OF MANY SHOPS
- 47. HEALTH CENTER.

- 45. NECKLACE OF COMMUNITY PROJECTS
- 61. SMALL PUBLIC SQUARES
- 86. CHILDREN'S HOME

- 11. LOCAL TRANSPORT AREAS
- 23. PARALLEL ROADS
- 49. LOOPED LOCAL ROADS

- 31. PROMENADE
- 32. SHOPPING STREET

- 18. NETWORK OF LEARNING
- 42. INDUSTRIAL RIBBON

- 60. ACCESSIBLE GREEN





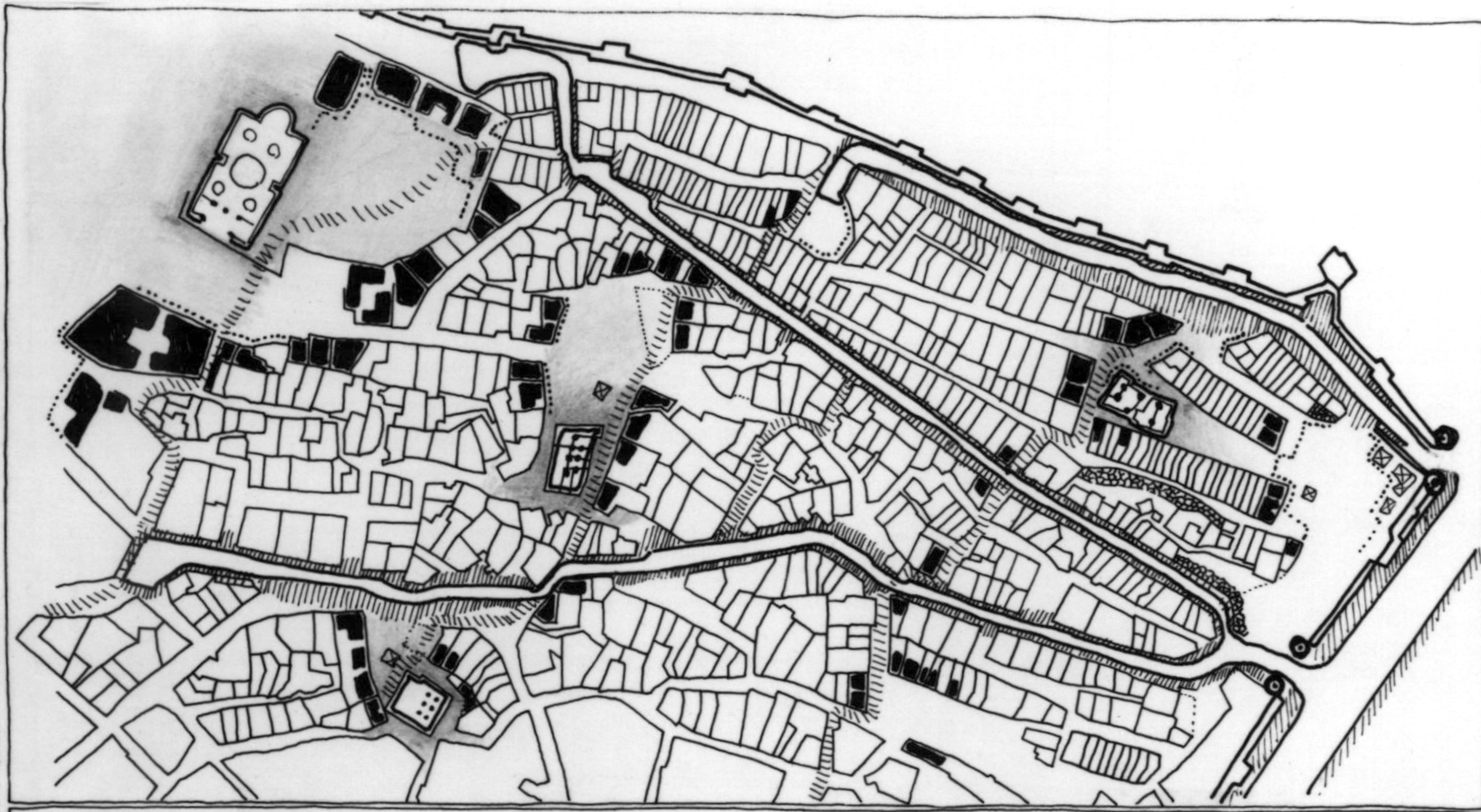

NEIGHBORHOODS

ALL LIFE CYCLES, ALL CLASSES, ALL SEXES, ALL SIZES OF FAMILIES ARE REPRESENTED IN NEIGHBORHOODS

IN NEIGHBORHOODS PUBLIC ACTIVITY AND DAILY LIFE IS CENTERED AROUND ACTIVITY NODES WITH:
 WORK COMMUNITIES, PUBLIC OUTDOOR ROOMS,
 STREET CAFES, SMALL SHOPS, FOOD STANDS ETC...

IN HOUSE CLUSTERS SEMI-PUBLIC ACTIVITY AND PRIVATE LIFE IS CENTERED AROUND COMMON SPACE

SEVERAL NEIGHBORHOODS

- 30. ACTIVITY NODES
- 26. LIFE CYCLES
- 36. DEGREES OF PUBLICNESS

- 14. IDENTIFIABLE NEIGHBORHOODS
- 15. NEIGHBORHOOD BOUNDARIES
- 33. NIGHT LIFE

- 41. WORK COMMUNITIES
- 69. PUBLIC OUTDOOR ROOMS
- 88. STREET CAFES
- 87. INDIVIDUALLY OWNED SHOPS
- 89. CORNER GROCERIES
- 93. FOOD STANDS

- 56. BIKE PATH & RACKS
- 57. CHILDREN IN THE CITY
- 52. NETWORK OF PATHS & CARS

- 8. MOSAIC OF SUBCULTURES
- 67. COMMON LAND
- 37. HOUSE CLUSTER
- 75. THE FAMILY
- 76. HOUSE FOR A SMALL FAMILY
- 77. HOUSE FOR A COUPLE
- 78. HOUSE FOR ONE PERSON

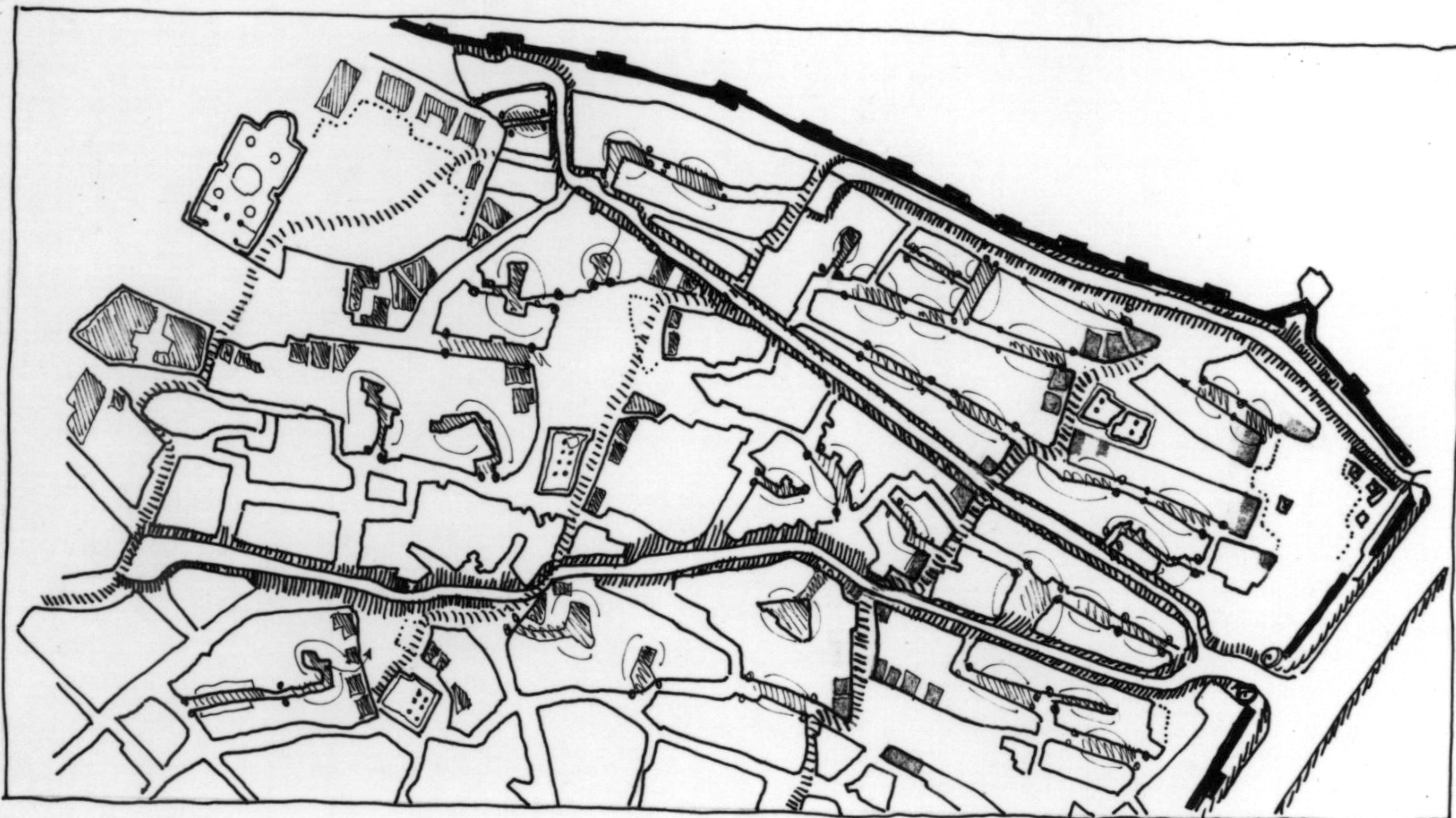

HOUSE CLUSTERS