

# 11. FOUNTAIN & BOOTH

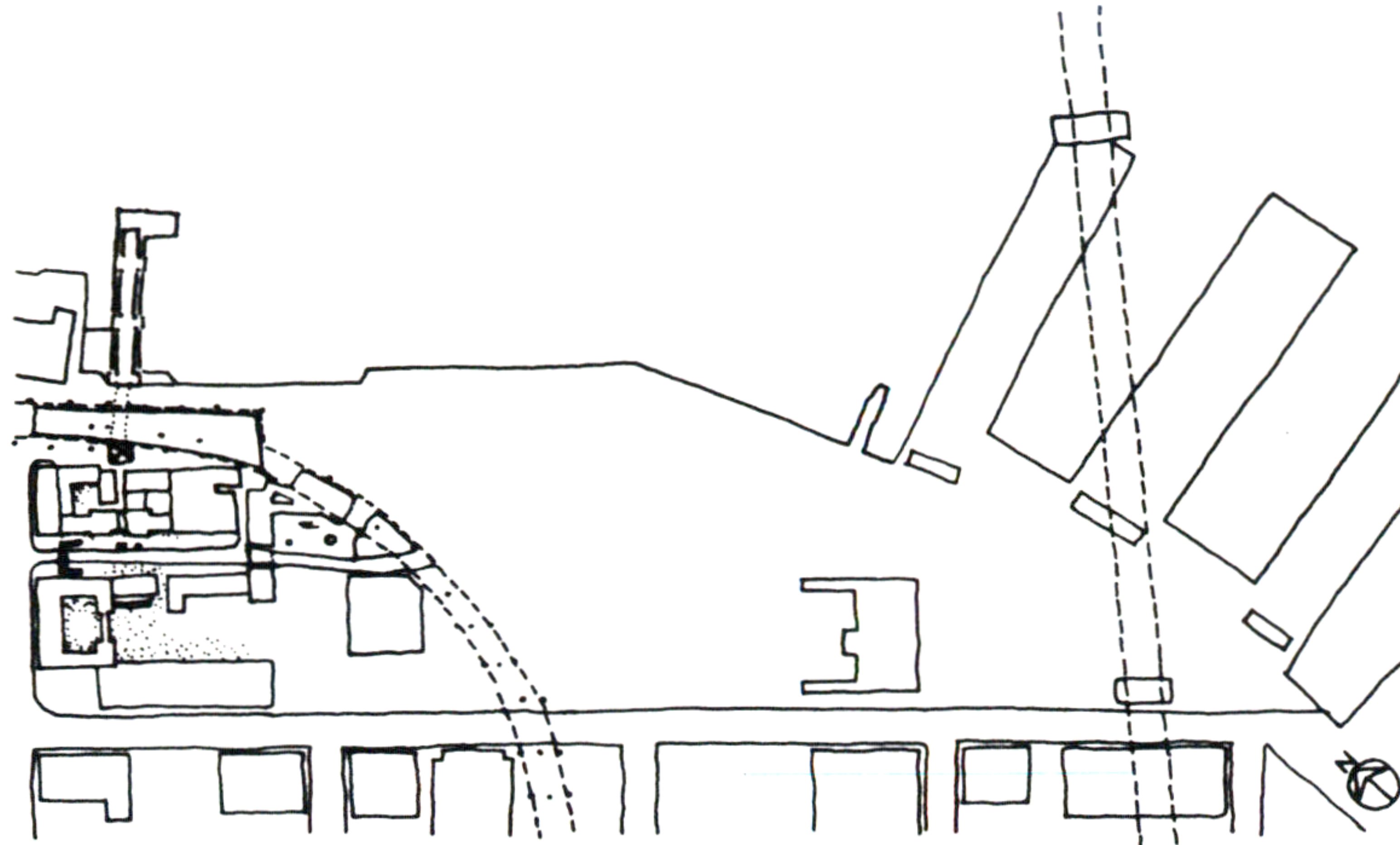

IN THE PLAZA FORMED BY THE COMMUNITY DEVELOPMENT OFFICES, I PROPOSE A FOUNTAIN, A FLOWER BOOTH, AND TWO ROWS OF CHAIRS.

PEOPLE ENTERING THE SITE THROUGH THE NORTH WESTERN GATEWAY, WHEN WALKING ALL THE WAY UP THE STREET WILL BE CONFRONTED WITH THE FOUNTAIN, AS WELL AS PEOPLE PASSING THROUGH THE GATE UNDERNEATH THE FREEWAY TOWARDS THE PLAZA. SO IN THIS SENSE THE FOUNTAIN ACTS VERY MUCH AS A POINT OF ORIENTATION. ALSO THE QUALITY OF IT WITH STEPS LEADING UP TO IT FOR PEOPLE TO SIT ON AND OCCASIONALLY LOWER THEIR LEGS INTO THE WATER IS SUCH THAT IT WILL BE A PLEASANT SPOT TO HANG AROUND.

THE BOOTH WILL BE AN 8' x 10' COVERED AREA WHERE FLOWERS, ICE CREAM, AND SANDWICHES ARE SOLD. IT IS LOCATED ON THE EDGE OF THE PEDESTRIAN SIDE WALK SO THAT IT WOULD BE CONVENIENT FOR PASSERS BY TO USE.

THE TWO ROWS OF CHAIRS, SOME COVERED WITH CANVAS UMBRELLAS, WILL BE LOCATED CLOSER TO THE EXHIBITION ROOMS ON THE GROUND FLOOR OF THE DEVELOPMENT OFFICES. THE CHAIRS ALONG WITH THE BOOTH WILL CREATE THE FEELING OF AN OUTDOOR CAFE IN THE PLAZA.

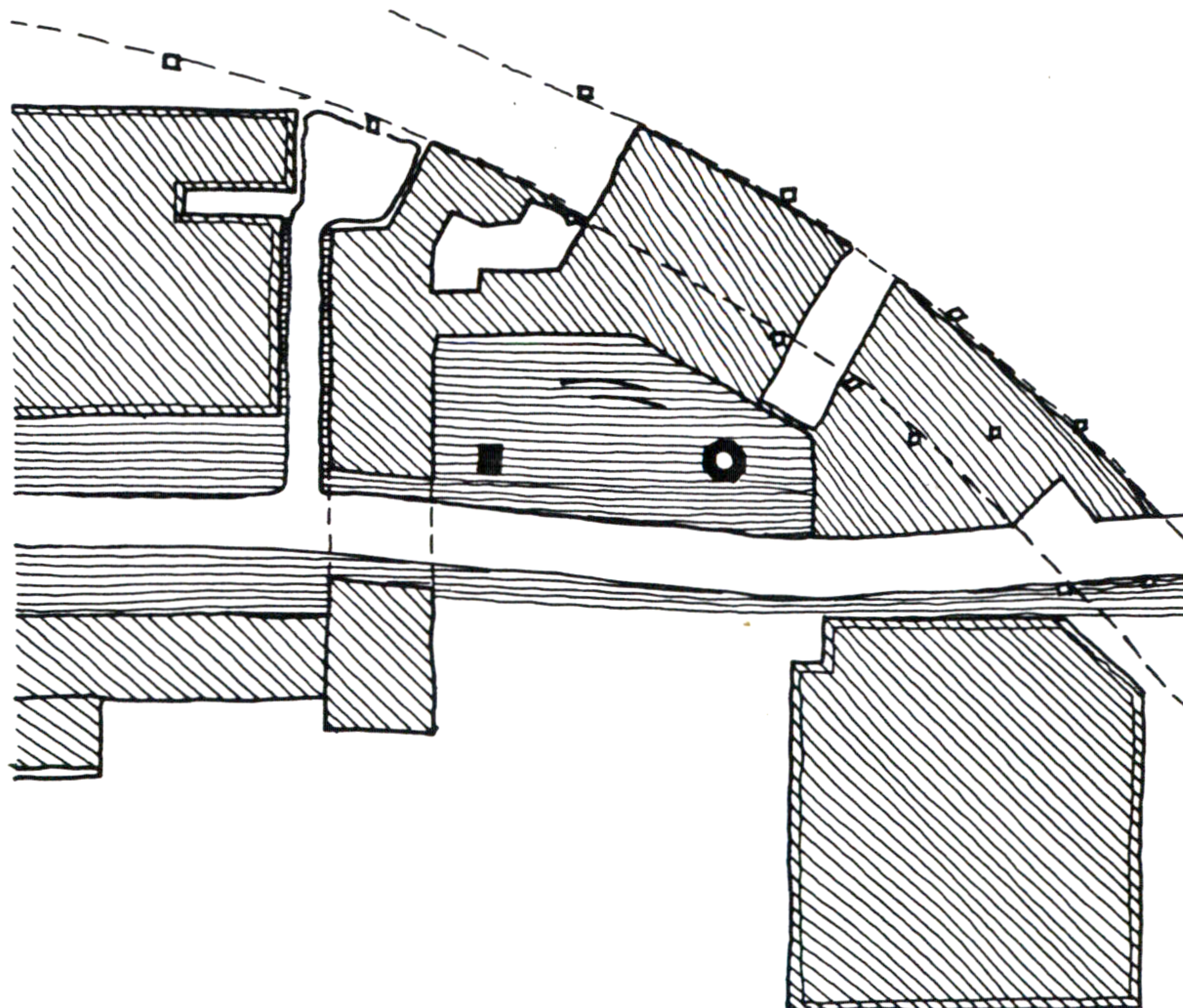



# 11. FOUNTAIN & BOOTH

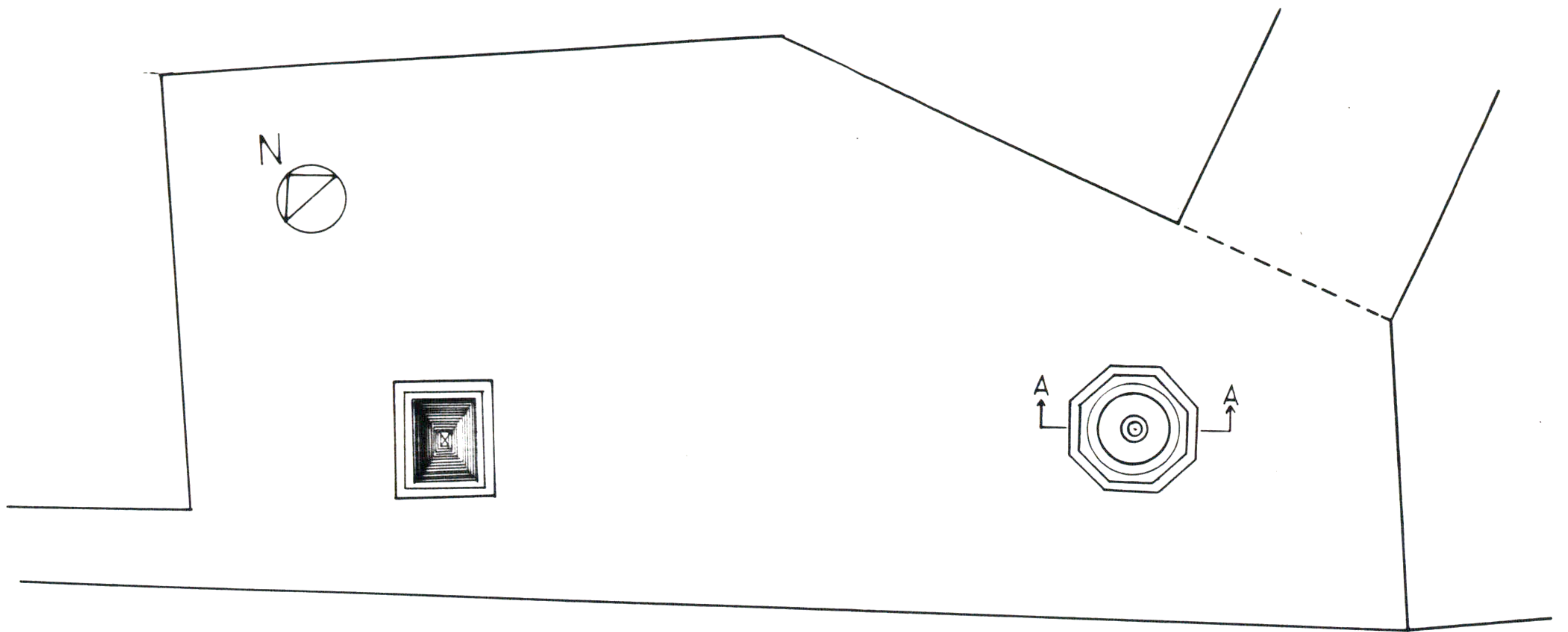

PLAN 0 10 20

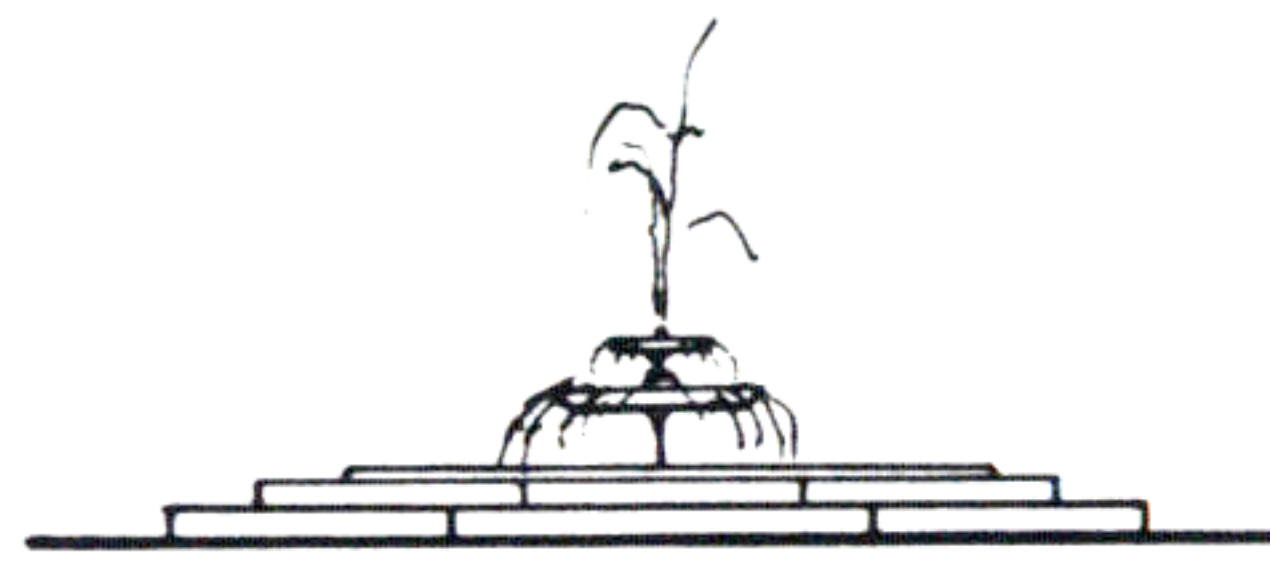

SW. ELEVATION 0 5 10

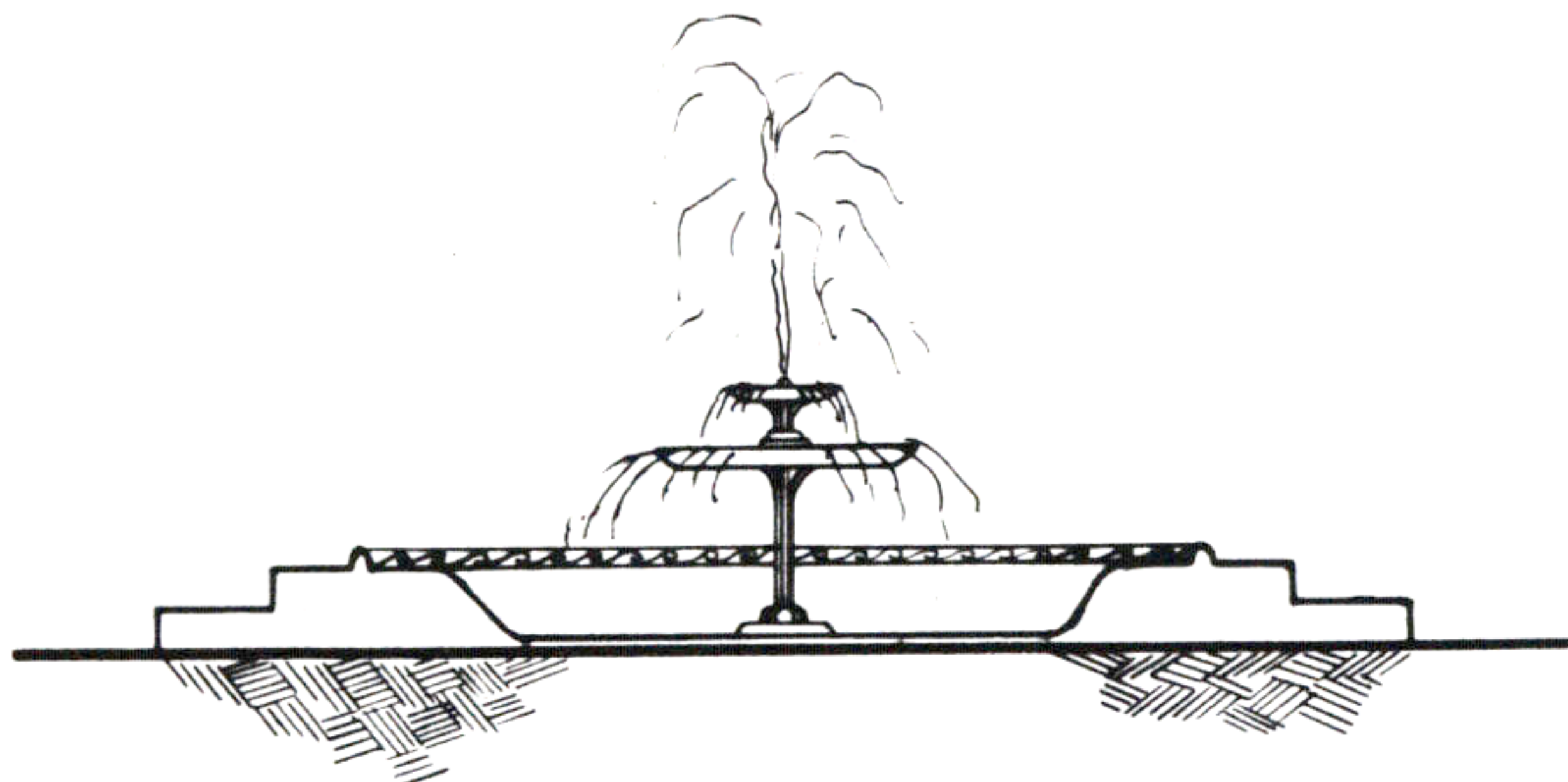

SECTION A-A

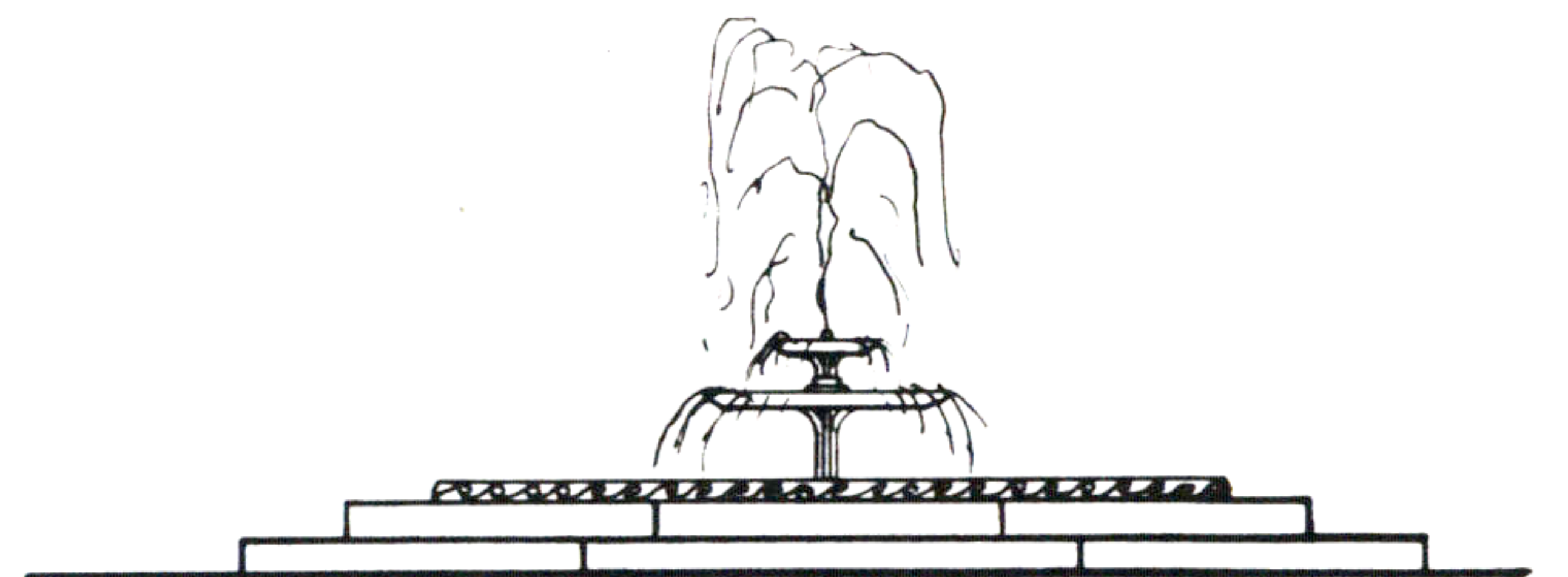

SW. ELEVATION

0 2 4 6

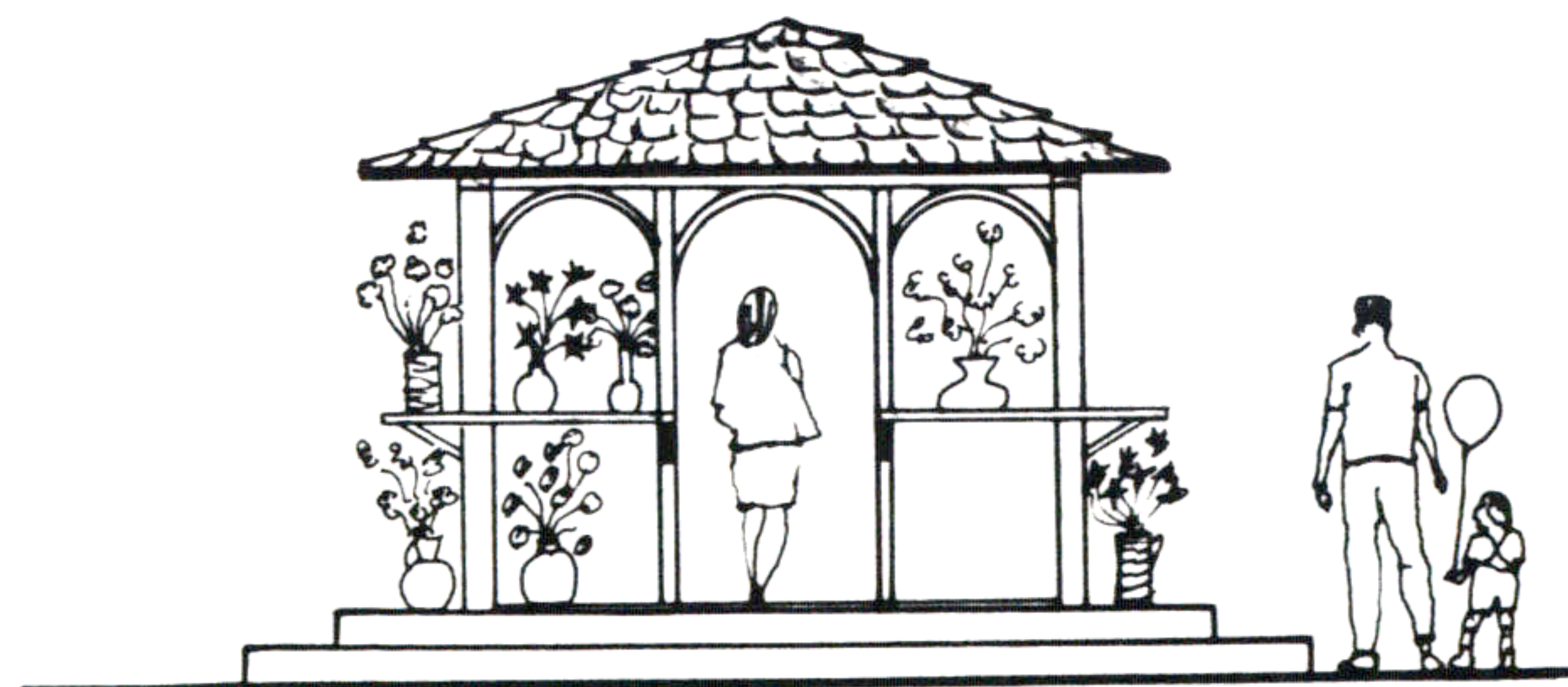

SE. ELEVATION

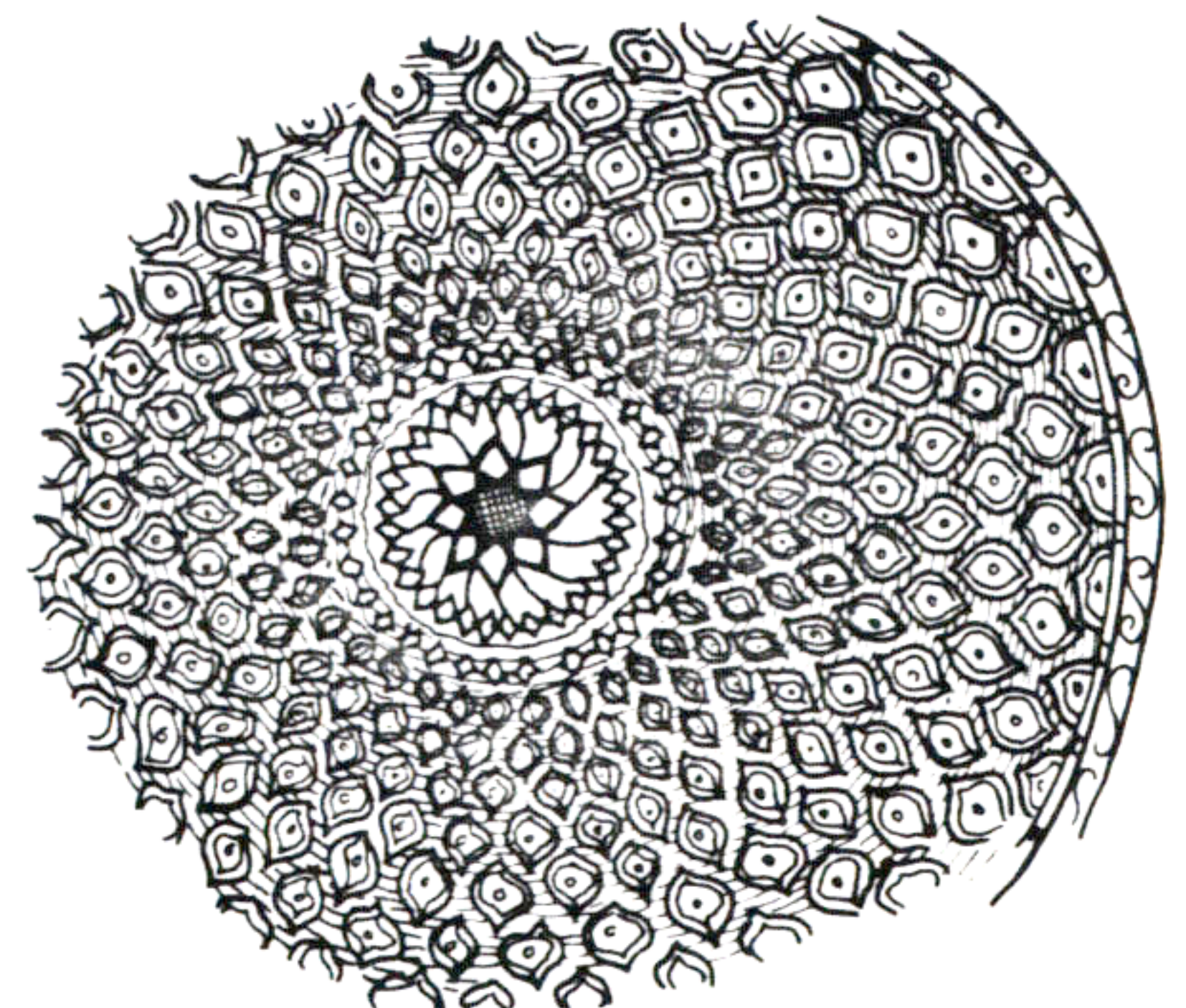

INTERIOR OF THE FOUNTAIN

**Shohreh Daemi**