

PROPOSAL FOR SATELLITE STUDENT UNION:

MUSIC DEPARTMENT AREA

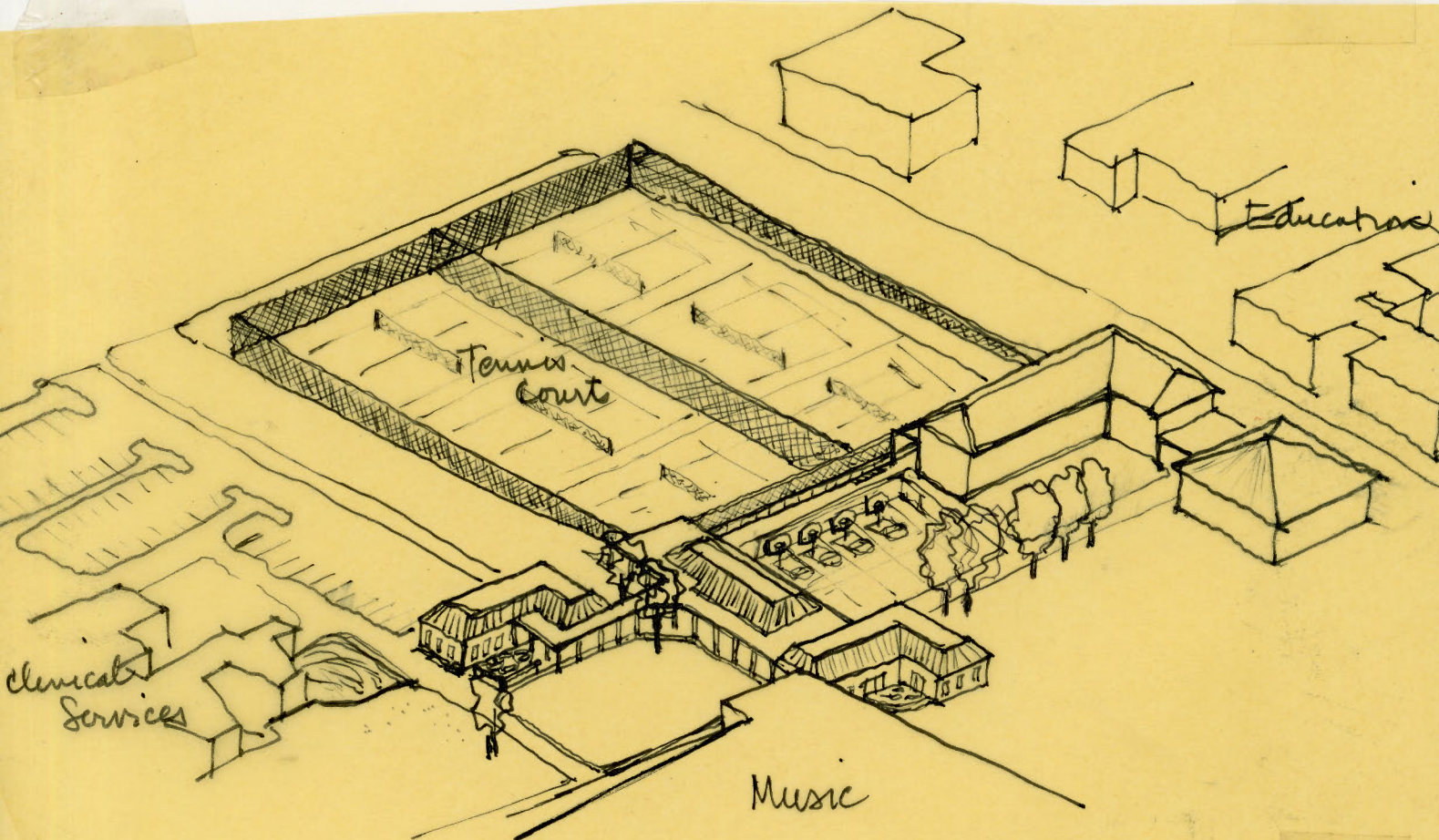

This is a project for a student union satellite near the Music Department. This project is part of the package of five satellites that we are offering as an alternative to the current proposal for additions to ERB Memorial Student Union.

Since this part of the campus is the furthest from ERB, the students would benefit greatly if the major union facilities were duplicated here - cafe, cafeteria, lounge, and games. In addition, it would make sense to make this a sport-oriented satellite because of the existing tennis courts and open fields nearby. Thus, we propose including a sauna, showerrooms, lockers, and indoor and outdoor games and courts.

FINAL PLAN

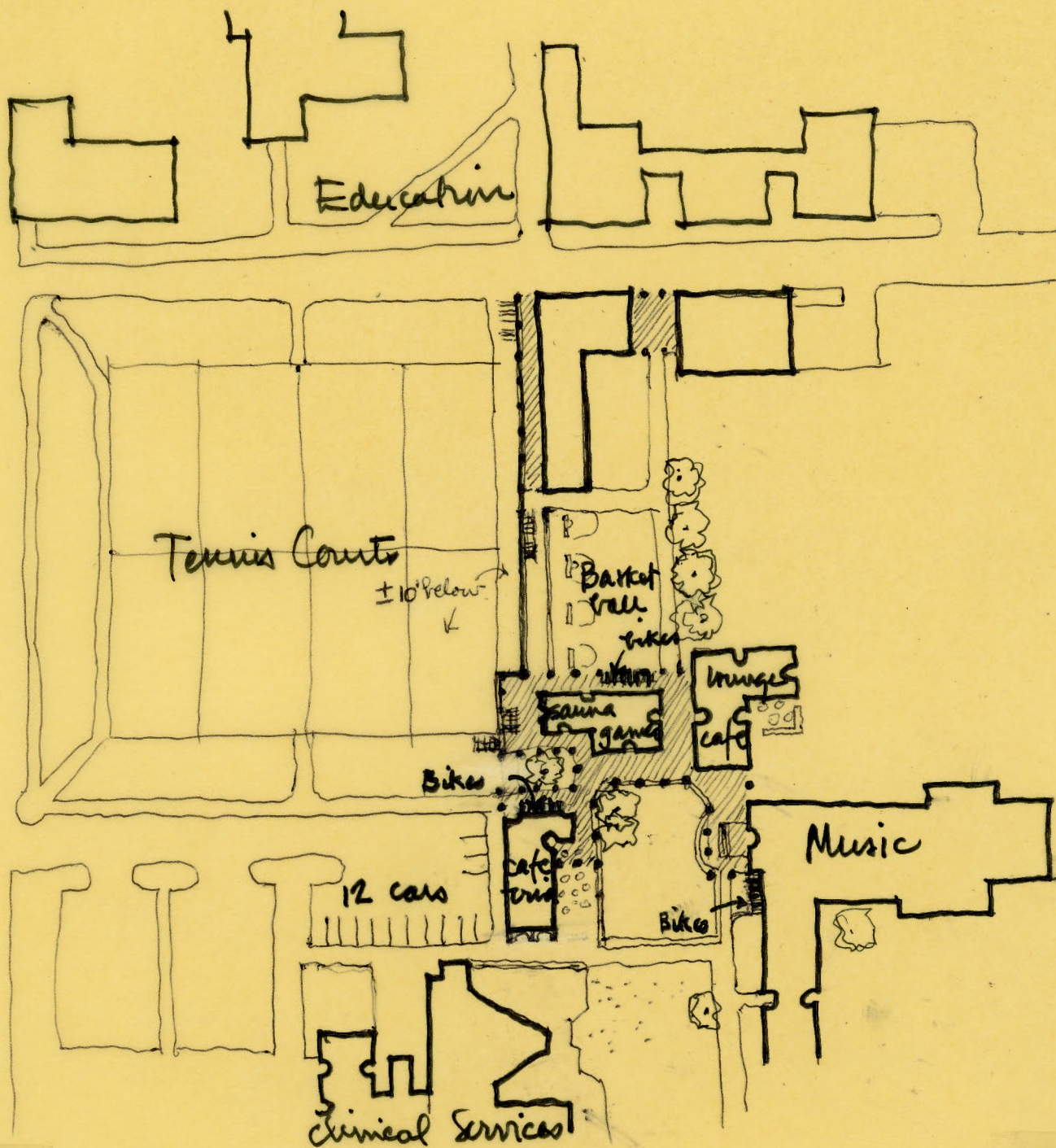

We now show the evolution of our plan for the Music Student Union Satellite in eight steps, according to the demands of the master plan. The eight steps are:

STUDENT GATHERING

PUBLIC BUILDING

PARKING

LOCAL ROADS

OUTDOOR PLACES

PEDESTRIAN PATHS

BIKE PATHS

ENTRANCES

STUDENT GATHERING

The sketch on this page portrays the impact of the following patterns on the design:

Activity Nuclei

No Isolated Student Union

From page 3 of the Proposal for the Addition to ERB, we have the following space allocation for the Music Student Union Satellite:

Dining 4,000 sq.ft.

Lounge 2,000 sq.ft.

Food Service 500 sq.ft.

For Sports, we propose the following:

sauna, 400 sq.ft.

shower 300 sq.ft.

lockers 300 sq.ft.

games 800 sq.ft.

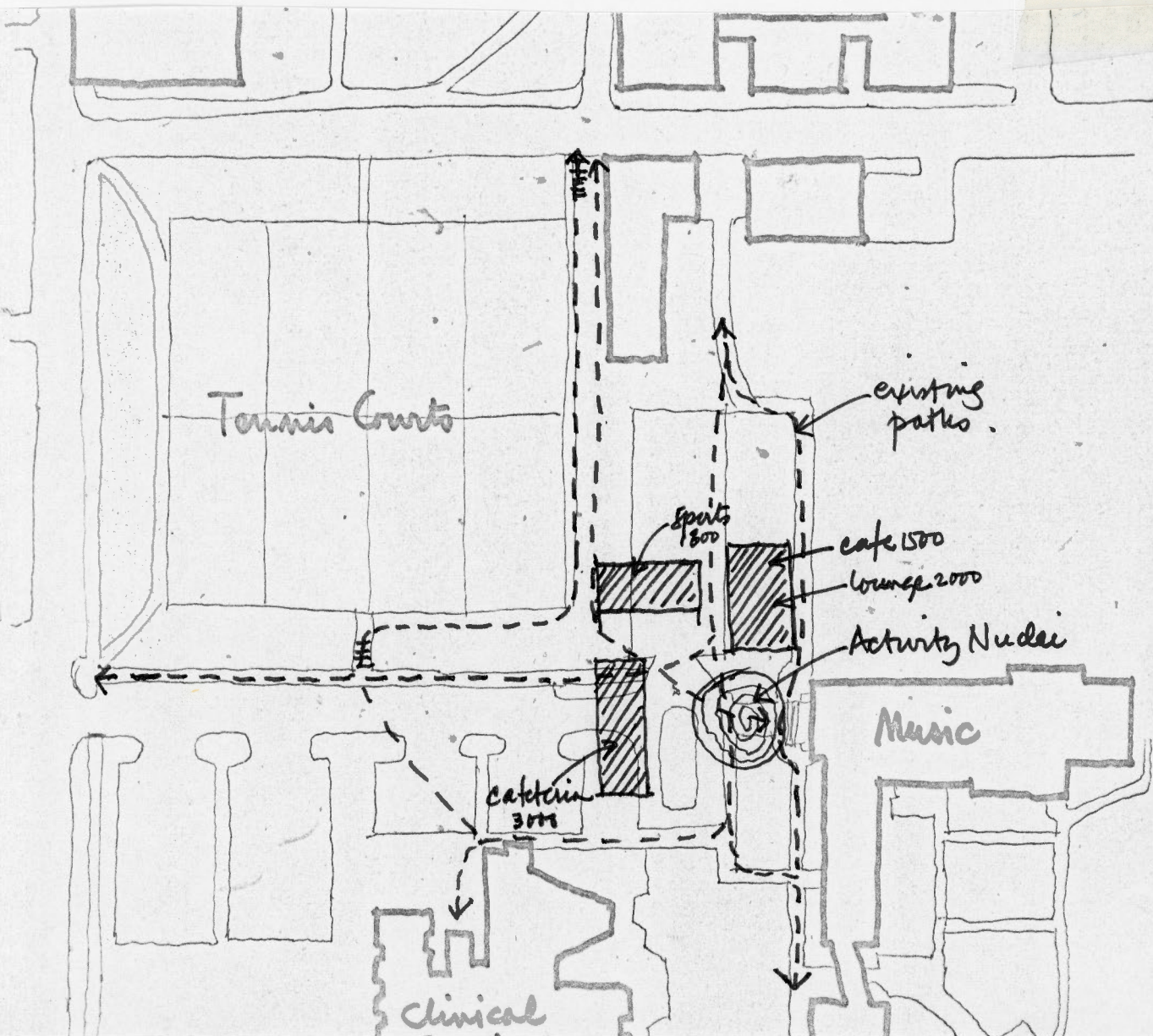

PUBLIC BUILDING

The sketch on this page adds the following patterns to the design:
Human Scale in Public Buildings
Buildings Shaped for Light
Horizontal Office Building

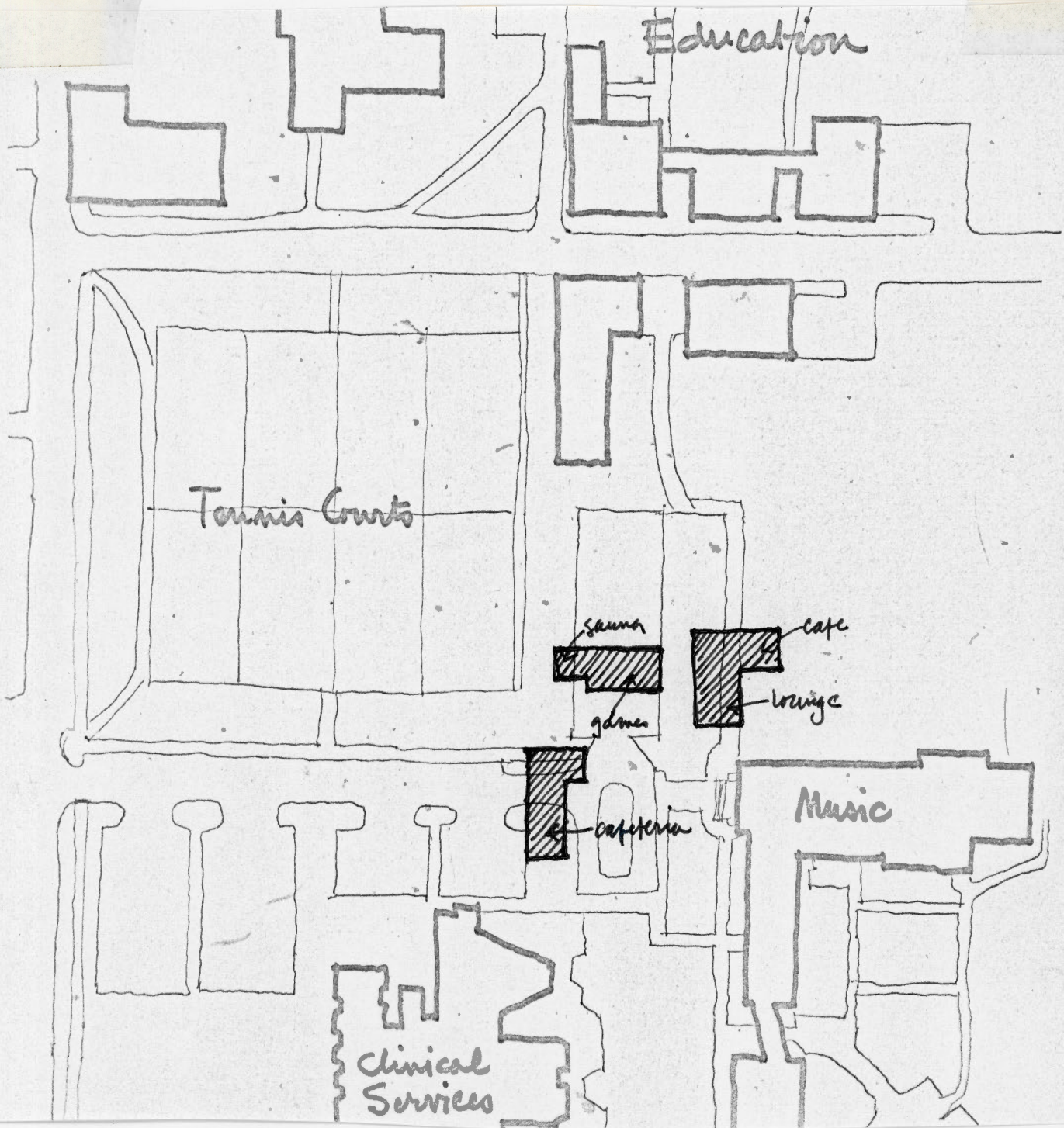

PARKING

The sketch on this page adds the following patterns to the design:

University Parking
Nine Percent Parking
Short Term Parking
Tiny Parking Lots

The Music Student Union Satellite generates the need for approximately 10 short parking spaces and 4 commuter parking spaces.

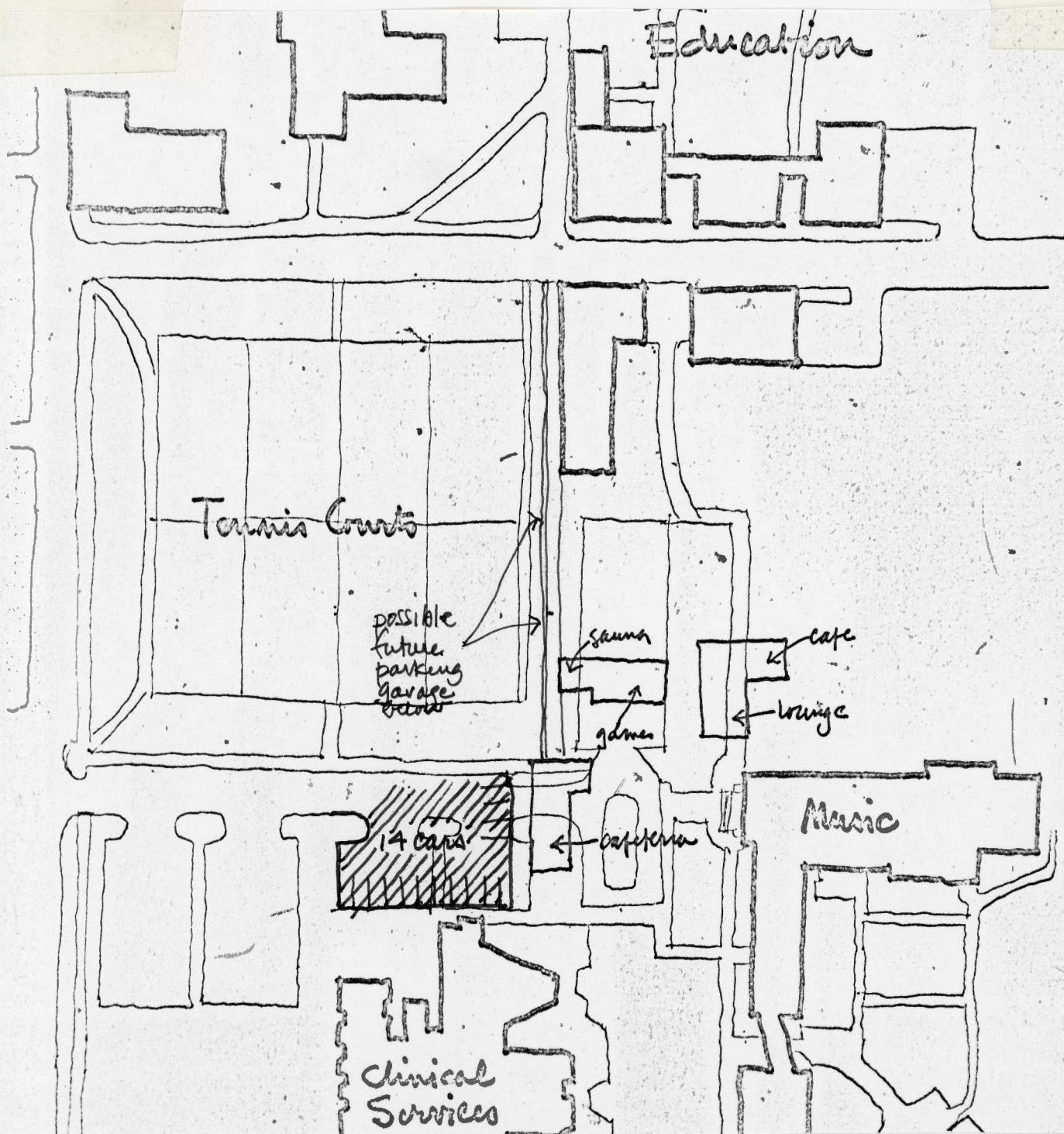

OUTDOOR PLACES

The sketch on this page adds the following patterns to the design:

Access to a Green

Convex Connected Outdoor Spaces

South Facing Open Space

Patios which Live

Trees Must Stay

Places at the Edges of Buildings

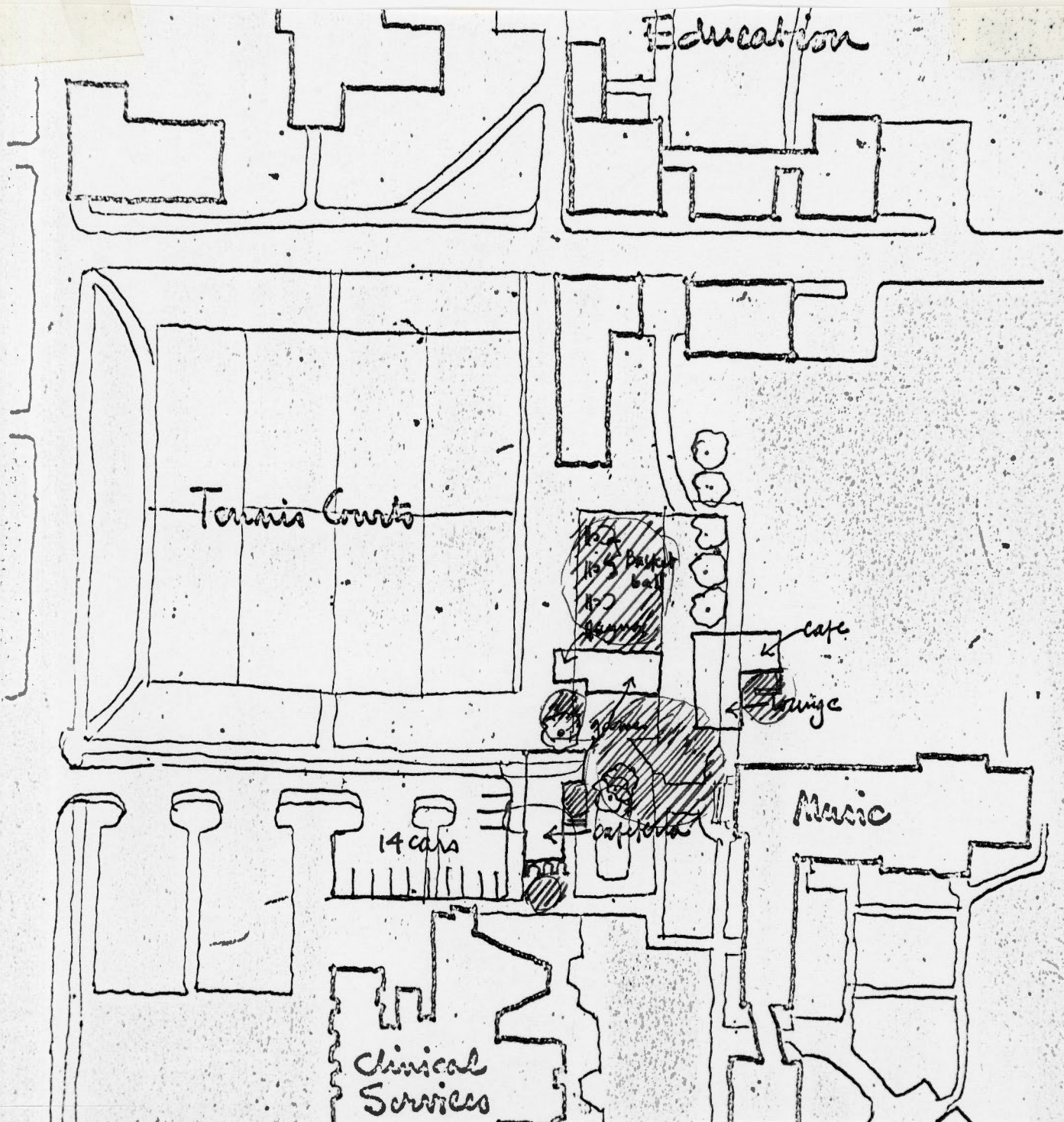

ENTRANCES

The sketch on this page adds the following patterns to the design:

Entrance Location

Circulation Realms

Territorial Ambiguity

Entrance Shape

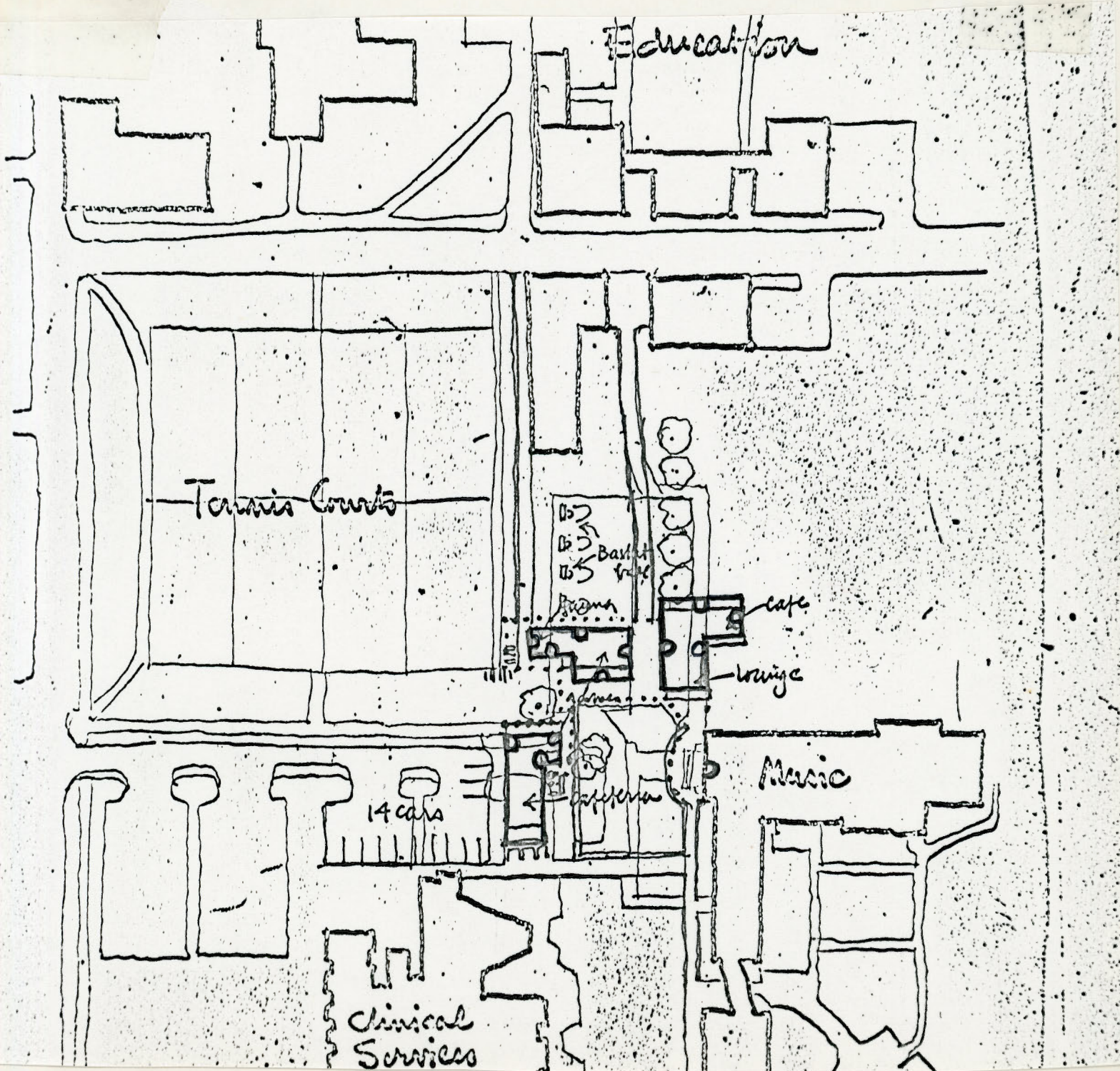

LOCAL ROADS

The sketch on this page adds the following patterns to the design:

Looped Local Roads

Car Pedestrian Symbiosis

T-Junctions

Paths Interrupt Roads

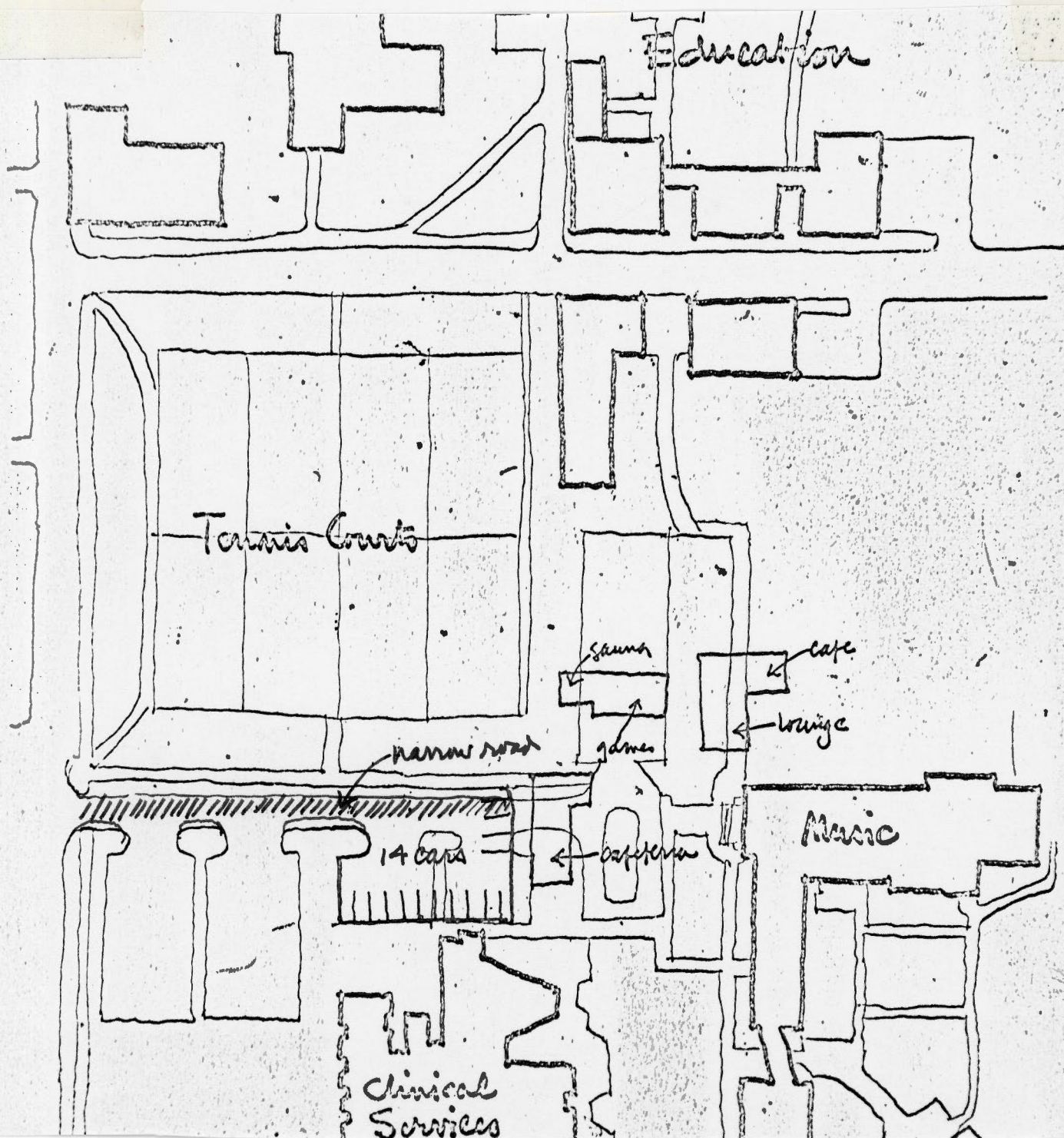

PEDESTRIAN PATHS

The sketch on this page adds the following patterns to the design:

Territorial Ambiguity

University as a Marketplace

Paths Interrupt Roads

Centripetal Pedestrian Paths

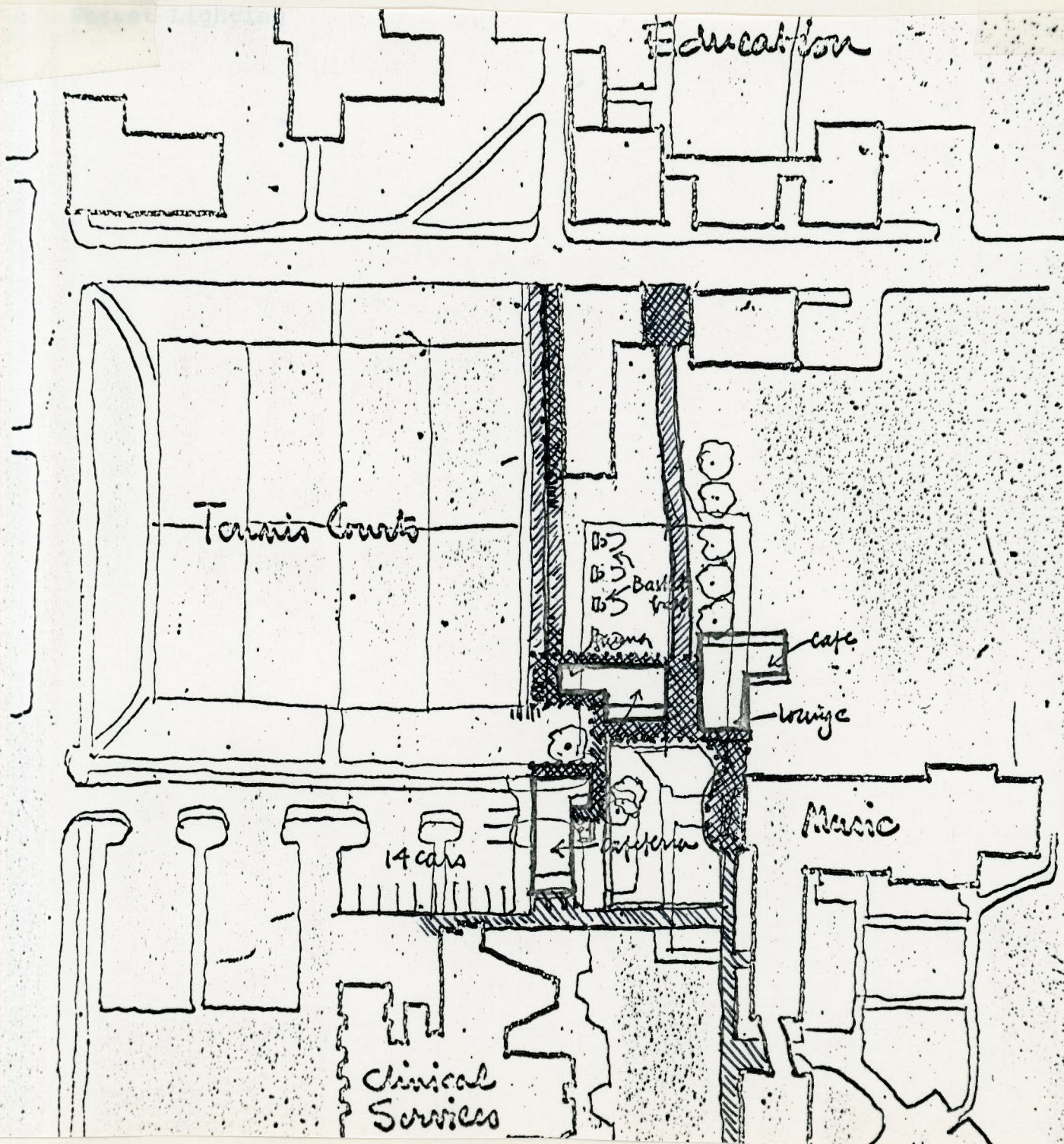

BIKE PATHS

The sketch on this page adds the following patterns to the design:
Bike Paths and Racks

