

## THE FIFTY KEY ELEMENTS

The system consists of about fifty key elements, which are listed below:

1. Doorways -- a thick doorway.

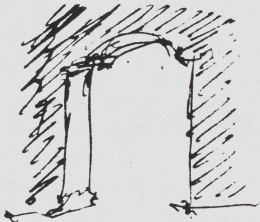

Height of opening  
Width of opening

2. A platform -- an elevated wood platform, on top of which the individual workplace is positioned.

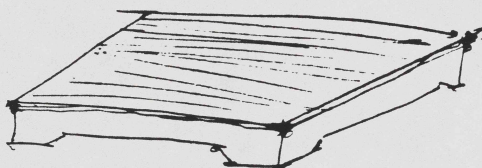

Height of platform  
Length of platform  
Depth of platform

3. Ceiling -- a flat ceiling with simple geometrical patterns.

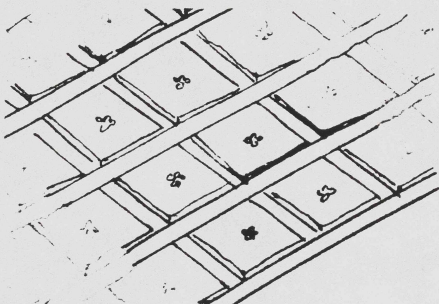

Depth of coffer  
Length of coffer  
Width of coffer



4. Table -- a conference table, to sit around and talk.

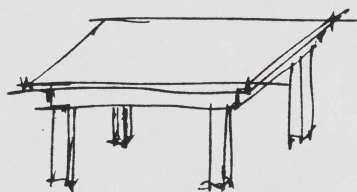

Height  
Depth of top  
Breadth of top

5. Chair -- an ordinary chair.



Height of the seat  
Depth of the seat  
Breadth of the seat  
Height of the back

6. Armchair -- a more comfortable chair.

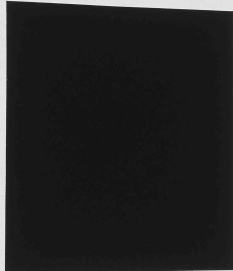

Height of the seat  
Depth of the seat  
Breadth of the seat  
Height of the back

7. Footrest.

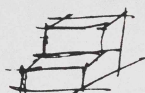

Height  
Width  
Number of steps  
Size of steps

8. Desk -- a top, like a table, with shelves and drawers behind, above.

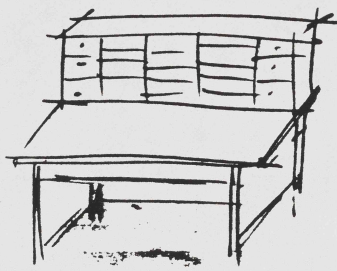

Height  
Depth of top  
Breadth of top  
Back or no back  
Height of back

Number of drawers  
Size of drawers  
Number of shelves  
Size of shelves

9. Columns -- simple columns, arising out of wall, and stiff and fairly thick.

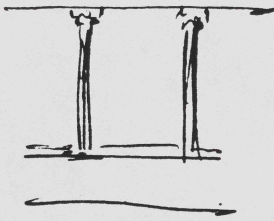

Number of columns  
Height of columns  
Dimensions of column section

10. A wall trellis -- thin bracing on top of low wall.

Height of wall  
Length of wall

11. Frieze -- a thing which goes around the wall below the ceiling -- with ornaments, or painted decorations on it.

Height of frieze  
Length of frieze

12. Low wall -- a platform thick wall, about 2 feet high.

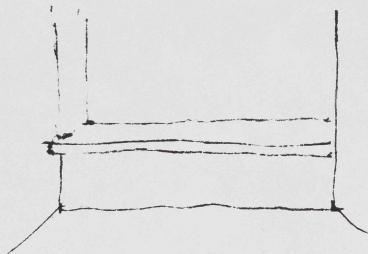

Height of wall  
Length of wall  
Thickness of wall



13. Layout table -- a larger table, like desk, but deeper, and backed with open shelves.

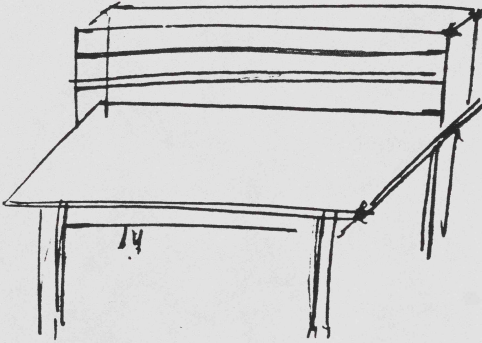

Height  
Depth of top  
Breadth of top

Number of shelves  
Size of shelves  
Back or no back  
Height of back

14. Bookcase-- free-standing open shelves.

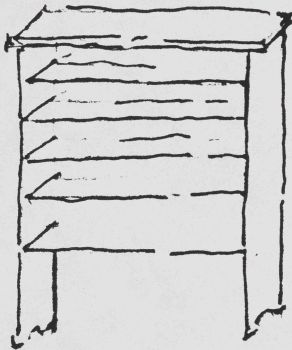

Total height  
Back or no back  
Number of shelves  
Size of shelves

15. A computer table -- a table with top that encloses the computer screen, with shelves on both sides.

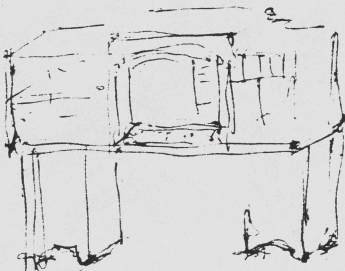

Height  
Depth of top  
Breadth of top

16. Side rolling cabinet -- a thing like a tool cabinet, that goes below a desk or table.

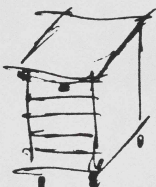

Height  
Depth  
Breadth

Number of drawers  
Number of shelves



17. Counter -- a counter top with shelves underneath it, or drawers.

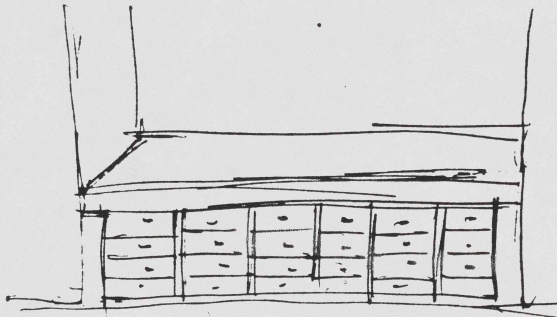

Height  
Depth of top  
Breadth of top

Number of drawers  
Size of drawers  
Number of shelves  
Size of shelves

18. Built-in counter -- a counter top with no legs built in a thick wall.

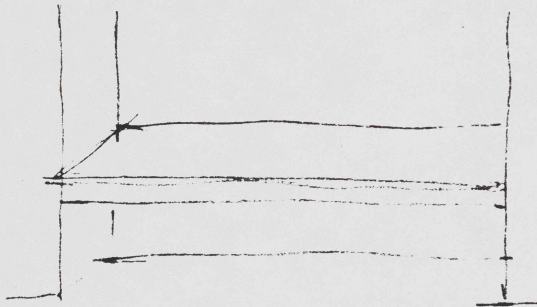

Height  
Depth of top  
Breadth of top

19. High counter -- a higher counter, on legs, with a series of vertical compartments, like record cabinet, and with bookshelves above it.

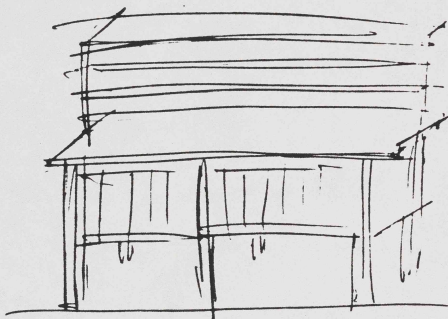

Height  
Depth of top  
Breadth of top  
Back or no back  
Height of back

Number of shelves  
Size of shelves  
Number of compartments

20. Domed or vaulted ceiling -- a gently domed or vaulted ceiling.

Depth of coffer  
Width of coffer





21. Small compartments, above wall.

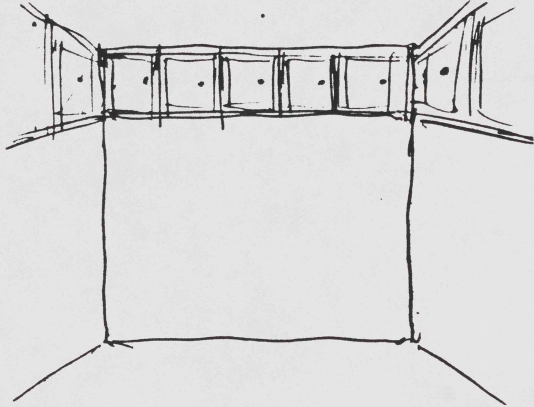

Number of compartments  
Size of compartments

22. Cupboard chest -- a tall chest with enclosed compartments and drawers.

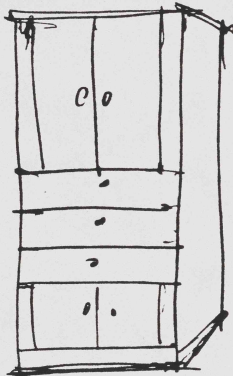

Height  
Depth  
Breadth

Number of drawers  
Size of drawers  
Number of compartments  
Size of compartments

23. Seat chest -- a seat with hinged seat portions, and storage underneath.

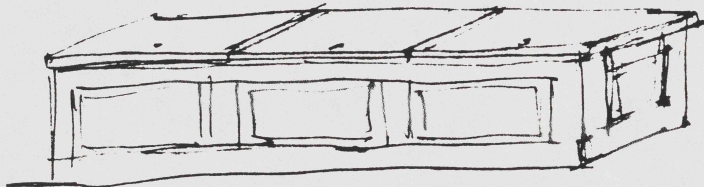

Height  
Length  
Depth  
Height of back

24. Filing cabinet -- a long and narrow cabinet with filing drawers.

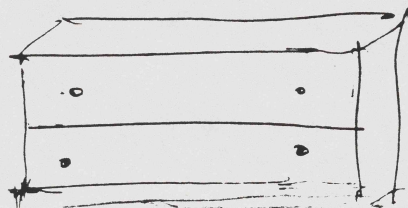

Height  
Size of drawers

Number of drawers



## 25. Stool



Height  
Size of seat

## 26. Mailbox cabinet -- an open cabinet with individual mail boxes.



Number of mailboxes  
Size of mailbox

## 27. Ladder -- a library-like ladder to reach storage compartments, high on the wall.

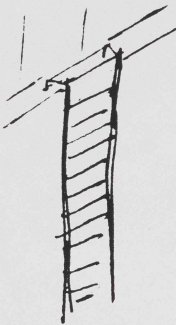

Height of ladder  
Width of ladder

## 28. Drapes, shades, screens -- a curtain-like enclosure, on a wall opening or between columns.

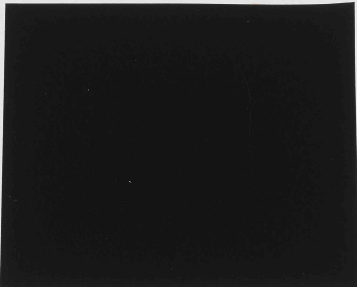

Height of opening  
Width of opening

## 29. Blackboard -- a real slate blackboard for drawing, writing.



Height of whiteboard  
Width of whiteboard



30. Information board -- a wall board made of cork or other soft material appropriate for pinning up paper.

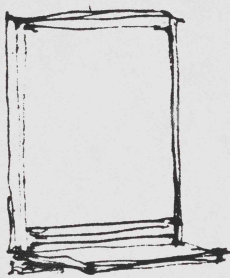

Height of board  
Width of board

31. Movable lights -- table and desk lights

32. Long hanging lights -- long light with splayed shade, for intense work area.

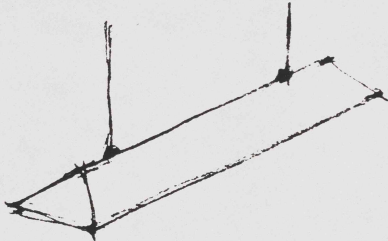

Length

33. Side rolling table -- a side movable table for auxiliary uses.

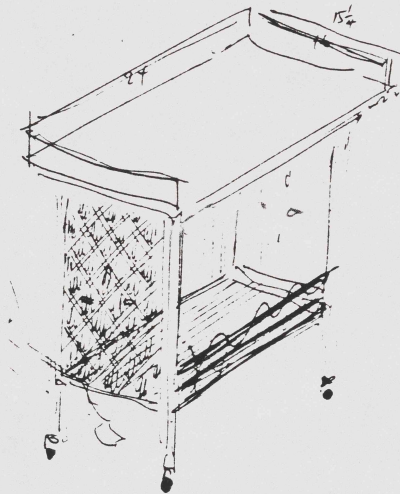

Height of table  
Width of top

34. Built-in drawers -- a chest of drawers, built in a thick wall.



Number of drawers  
Depth of drawers  
Width of drawers



35. Thick wall -- a thick enclosure for individual and group work space, with built-in shelves, drawers, cupboards, counter tops.

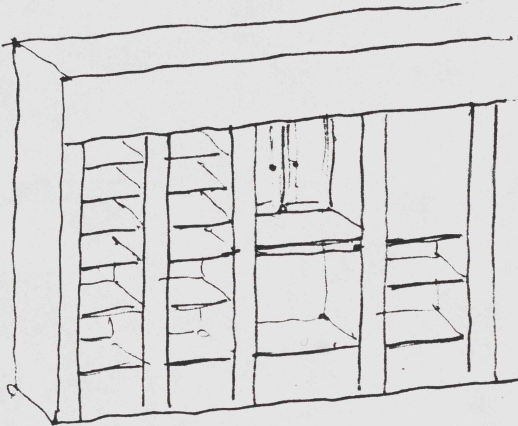

Length of wall  
Height of wall  
Depth of wall  
Kind of built-ins  
- Number of shelves  
- Number of drawers  
- Number of cupboards

36. Floor -- a floor with simple patterns

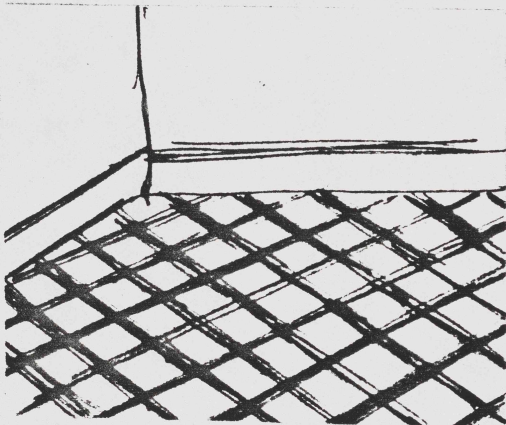

Area of floor

37. Alcove -- a small place, part of a group workspace for private discussions, phone calls ...with built-in furniture.

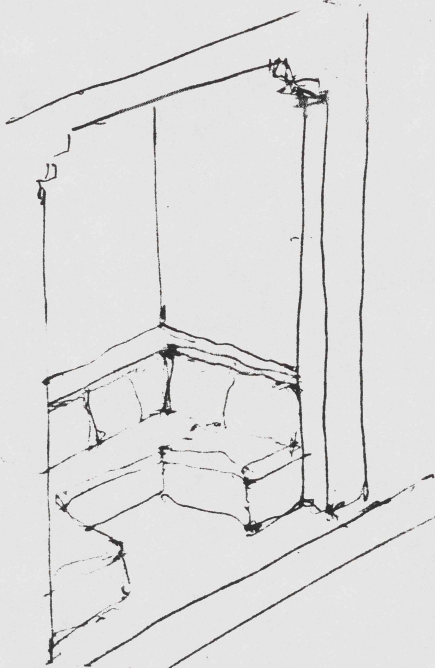

Length of alcove  
Height of alcove  
Depth of alcove  
Type of built-in furniture  
- Seat  
- Counter  
- Small table



38. Interior window -- an wall opening between workplaces, with glazed or solid window.

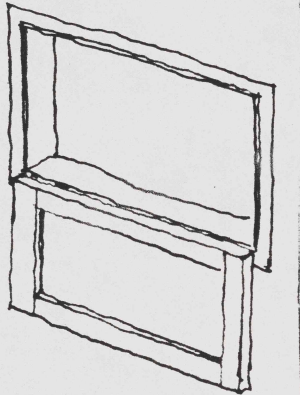

Height of window  
Width of window

39. Door -- a regular opening door, or a sliding door, single or double.

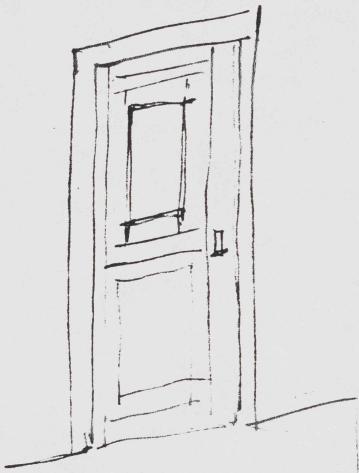

Height of door  
Width of door  
Window or no window

40. Sofa -- a comfortable upholstered couch, with pillows.



Length of sofa  
Depth of sofa  
Height of sofa  
Height of back

41. Built-in cupboards -- a chest of shelved cupboards, built in a thick wall.

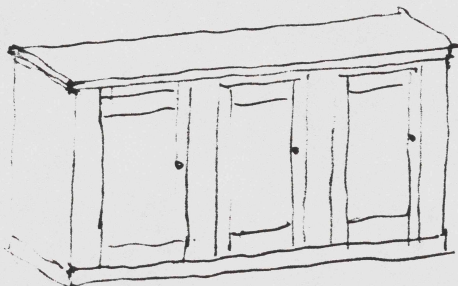

Number of cupboards  
Height of cupboard  
Depth of cupboard



42. Built-in shelves -- set of shelves built in a thick wall

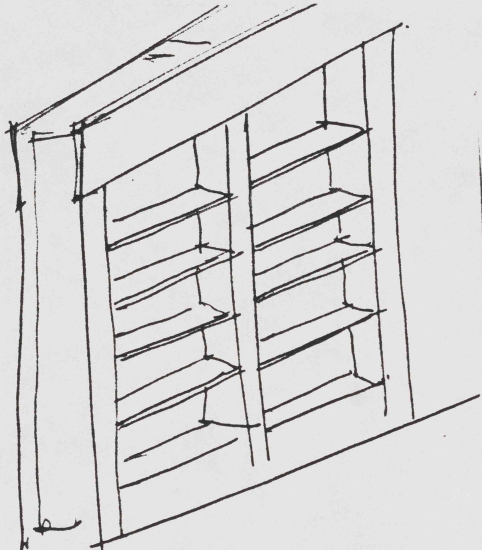

Number of shelves  
Width of shelves  
Depth of shelves  
Height of shelves

43. Catalog counter -- a counter with a slopping top built in a thick wall

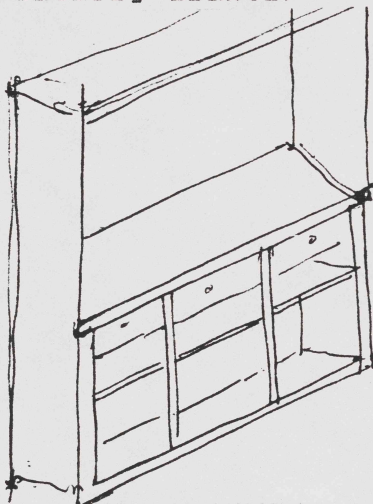

Height of counter  
Depth of counter  
Angle of top

44. Ceiling light -- flat lit panel let into ceiling.

Size of panel

45. Wall light -- a small light attached to the wall, that provides indirect lighting.

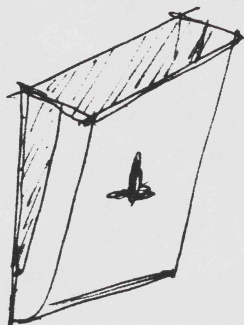

Size of light



46. Lounge table -- a long rectangular table with two benches.

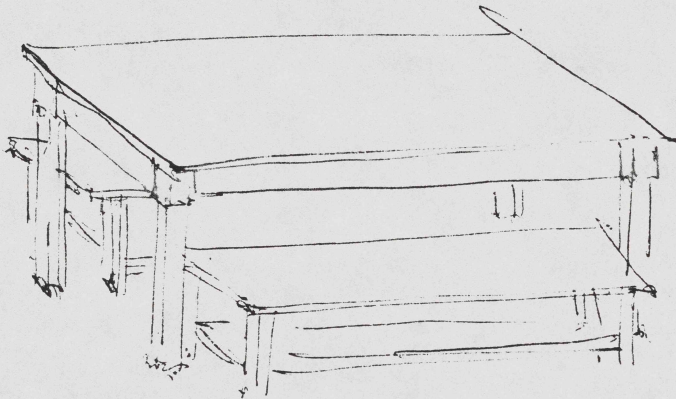

Height of table  
Width of table  
Length of table  
Height of bench  
Length of bench  
Width of bench

47. Desk chair -- a rolling chair with adjustable back.

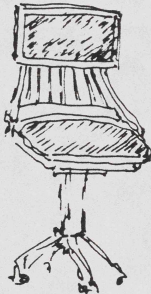

48. Chair with arms .

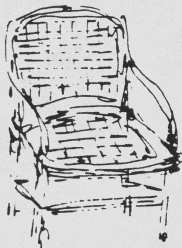

49. Wastebasket.